

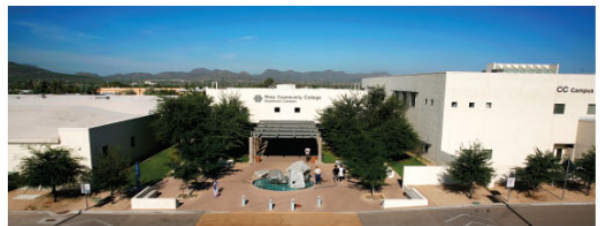

Guidelines for Social Distancing Instructional Space Protocols

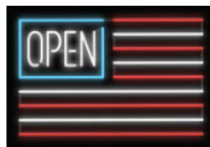
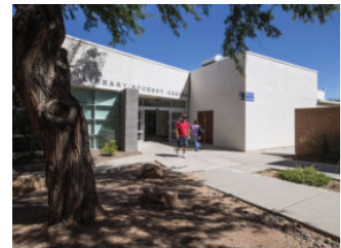

Summer 2020

Introduction

This document illustrates recommended layouts for instructional learning spaces throughout the College utilizing the latest [Center for Disease Control and Prevention](#), the [Arizona Department of Health Services](#), and the Pima County Health Department [Guidelines](#) for Social Distancing. All of the layouts depicted in this document are using the existing classroom furniture and a staggered desk assignment for students.

Facilities Reentry Protocol

COVID-19 Restrictions

Individuals that meet any of the following criteria must not enter College facilities:

- Have been diagnosed with positive COVID-19 by a medical provider.
- Have been in close contact with a person known to have COVID-19 within the last fourteen (14) days.
- Displays known COVID19 symptoms, including but not limited to:
 - Fever – The CDC considers a person to have a fever when he or she has a measured temperature of at least 100.4°F {38°C}
 - Cough
 - Shortness of breath
- Individuals who are sick must stay home and contact their health care provider for further directions.

Access Protocol

Access requests must be received at least 72 hours prior to arrival time.

- 1) **Employees** must email their supervisor and be clear on the details and purpose. Requests should be routed to the Executive Administrator for approval and strictly scrutinized prior to authorizing. The Executive Administrator will send an email to Acting Chief of Police requesting approval for entry.

Contractors/Tenants request access authorization through the sponsoring unit/department representative. Sponsoring unit/department will send an email to Acting Chief of Police requesting approval for entry.

- 2) Notify College Police dispatch when arriving/leaving the facility on a daily basis at 520-206-2700.
- 3) Access to any of our facilities will be approved or denied by the Chief of Police.
 - a) Approval will be sent to EH&S to provide Personal Protective Equipment (PPE).
 - b) Contractors are responsible for their own personal protective equipment, unless other arrangements have been made in advance.
- 4) Access is granted for the day/time approved only.
- 5) Go directly to the designated checkpoint at each location (see attached maps) to sign-in.

- a) PPE will be available at the check-in point.
- b) Temperature screening will be conducted at the check-in point.
- 6) Go directly to ONLY the area for which access was approved.
- 7) Time limit - 30 minute MAX. or as approved to cover instructional session duration.
- 8) Return to the designated checkpoint to sign-out.

Personal Protective Equipment

Gaining access requires individuals to wear the following PPE:

- Gloves
- Mask

What is social distancing?

Social distancing, referred to as “physical distancing,” means maintaining space between yourself and other people outside of your home. To practice social or physical distancing:

- Stay at least 6 feet (about 2 arms’ length) from other people
- Do not gather in groups
- Avoid crowded places and mass gatherings

Instructional Layout and Programming:

- Coordinate temperature check station locations with campus leadership
- Plan temporary check-in locations for faculty and students
- Install directional and instructional signage throughout
- Seating tagged with color-coding
- Sanitization services provided by custodians in between layout options rotations

Staggered Desk Assignment

- Alternating Classes
- No Desk Sharing
- Reduce sanitization required between each class

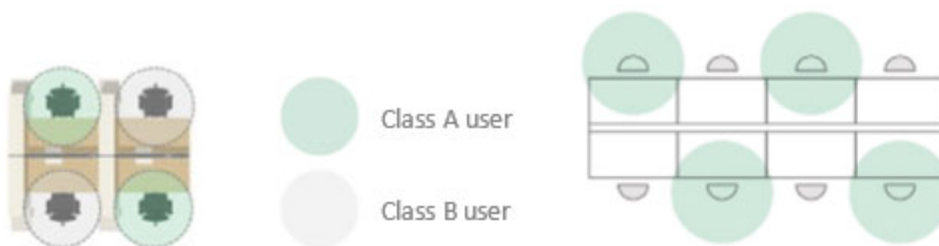

Wave 1

Courses described below:

Open Date	Location	Areas	Program
6/8/2020	ATC	All center	Aviation
6/8/2020	East	EMT area	EMT
6/8/2020	East	Vet area	Vet Tech
6/8/2020	West	Ground H	Radiology
6/8/2020	West	Ground H	Respiratory
6/8/2020	West	K Building	Dental Hygiene
6/8/2020	West	K Building	Medical Lab Tech
6/8/2020	West	K Building	Dental Lab tech

Aviation Technology Center

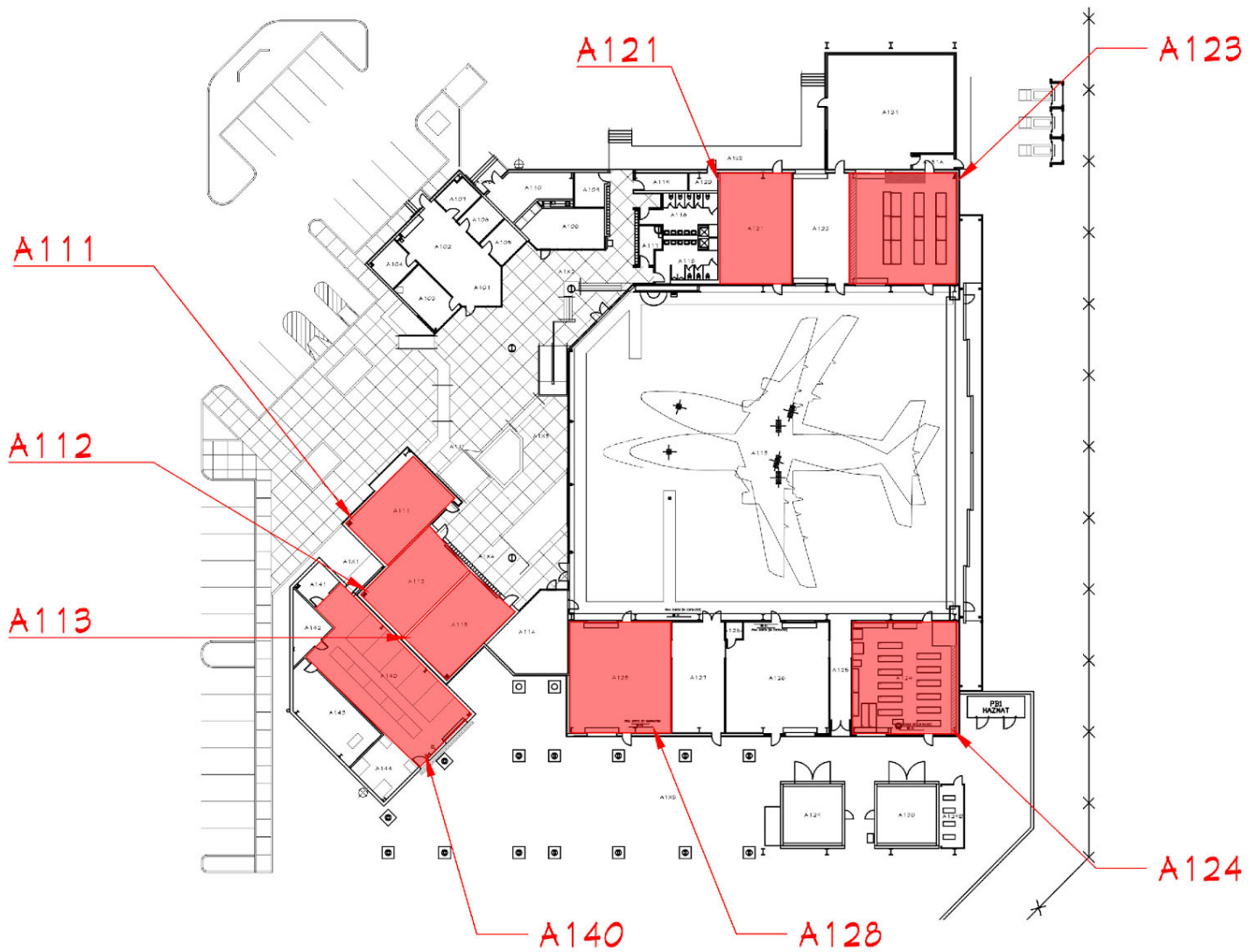

Aviation Technology Program
A111

Classroom Layout	Number of students
Class A (Blue)	12 students

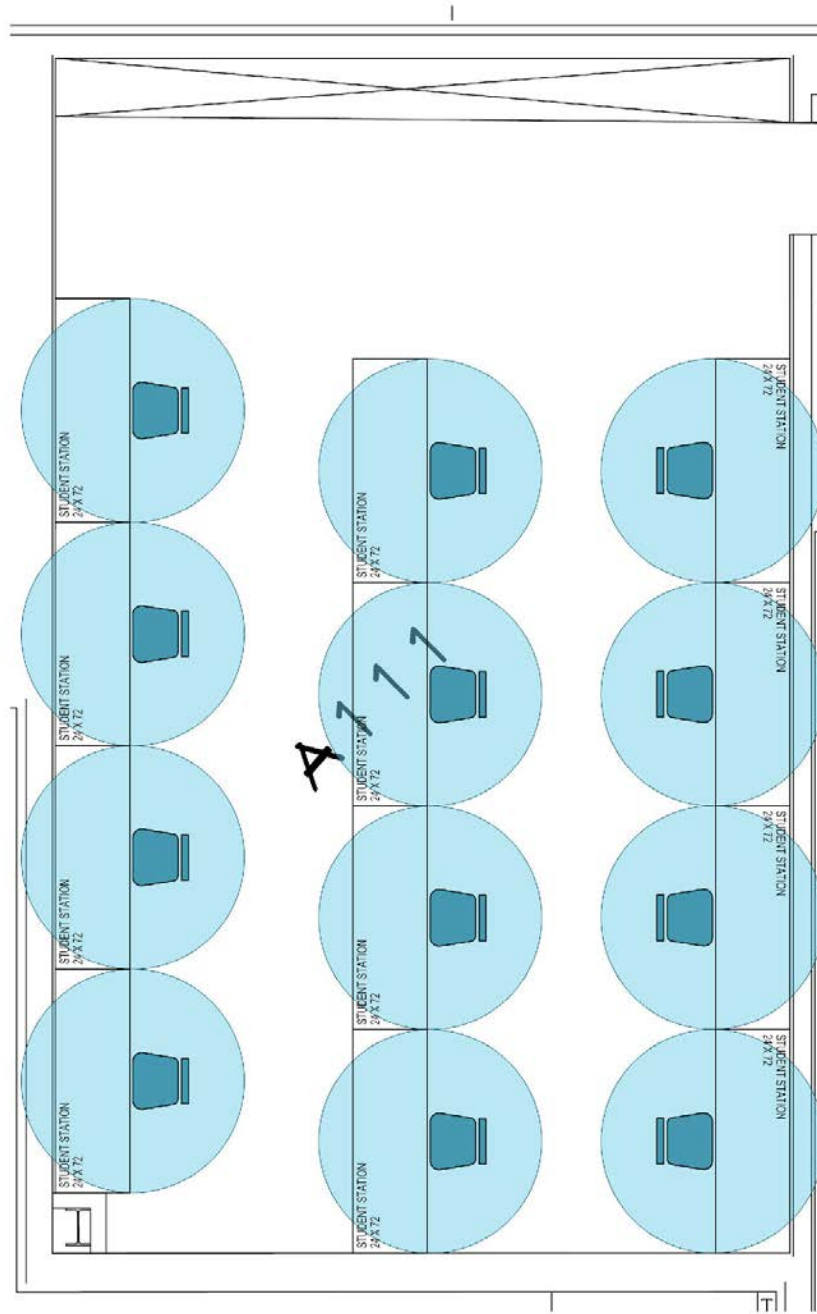

Aviation Technology Program
A112

Classroom Layout	Number of students
Class A (Blue)	12 students

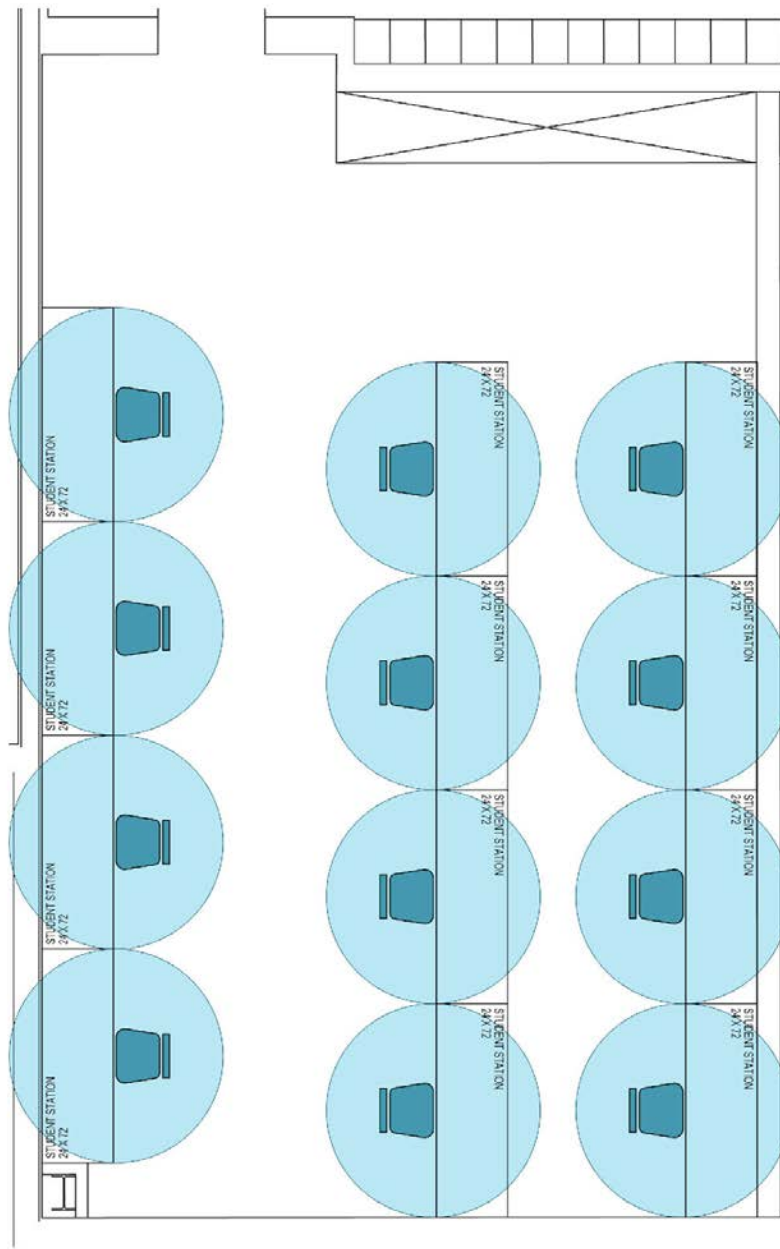

Aviation Technology Program
A113

Classroom Layout	Number of students
Class A (Blue)	12 students

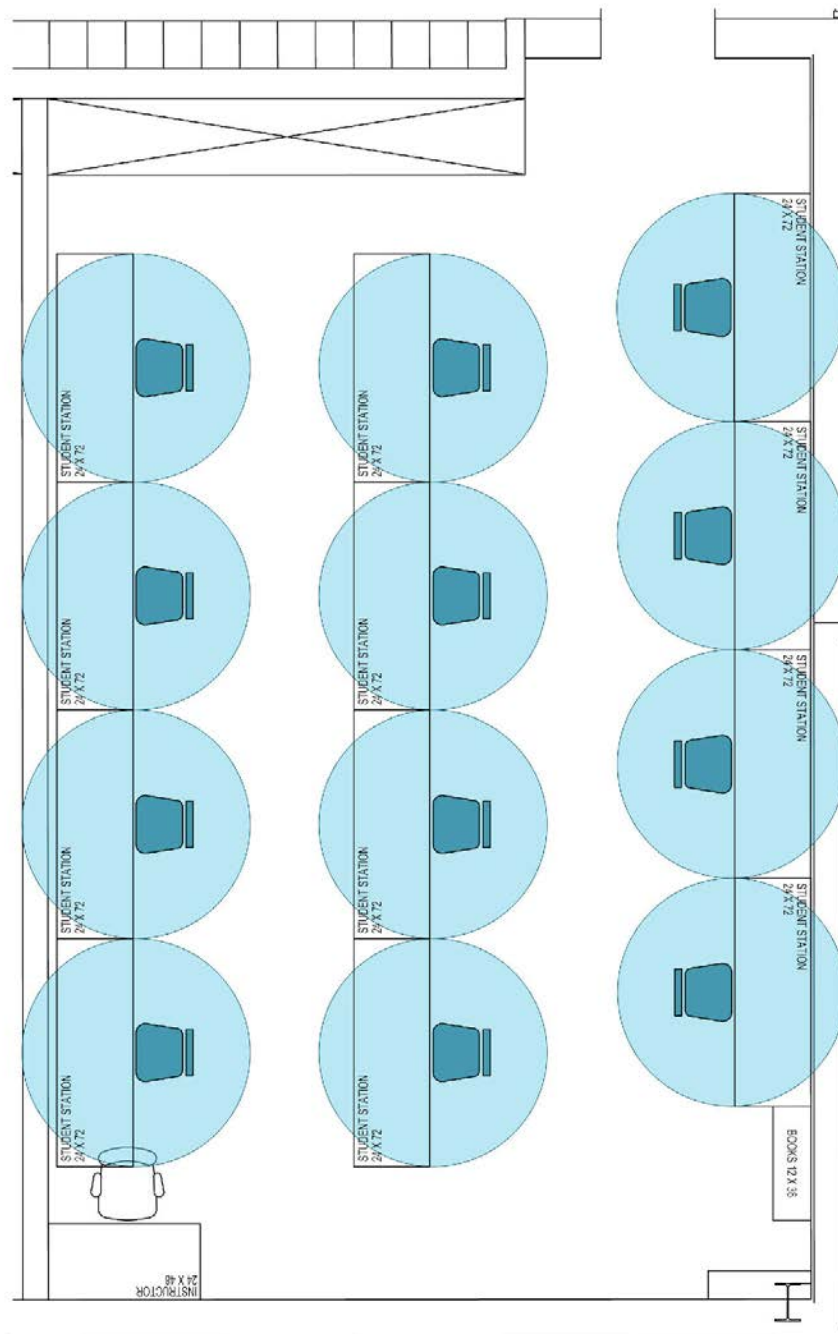

Aviation Technology Program
A121

Classroom Layout	Number of students
Class A (Blue)	14 students

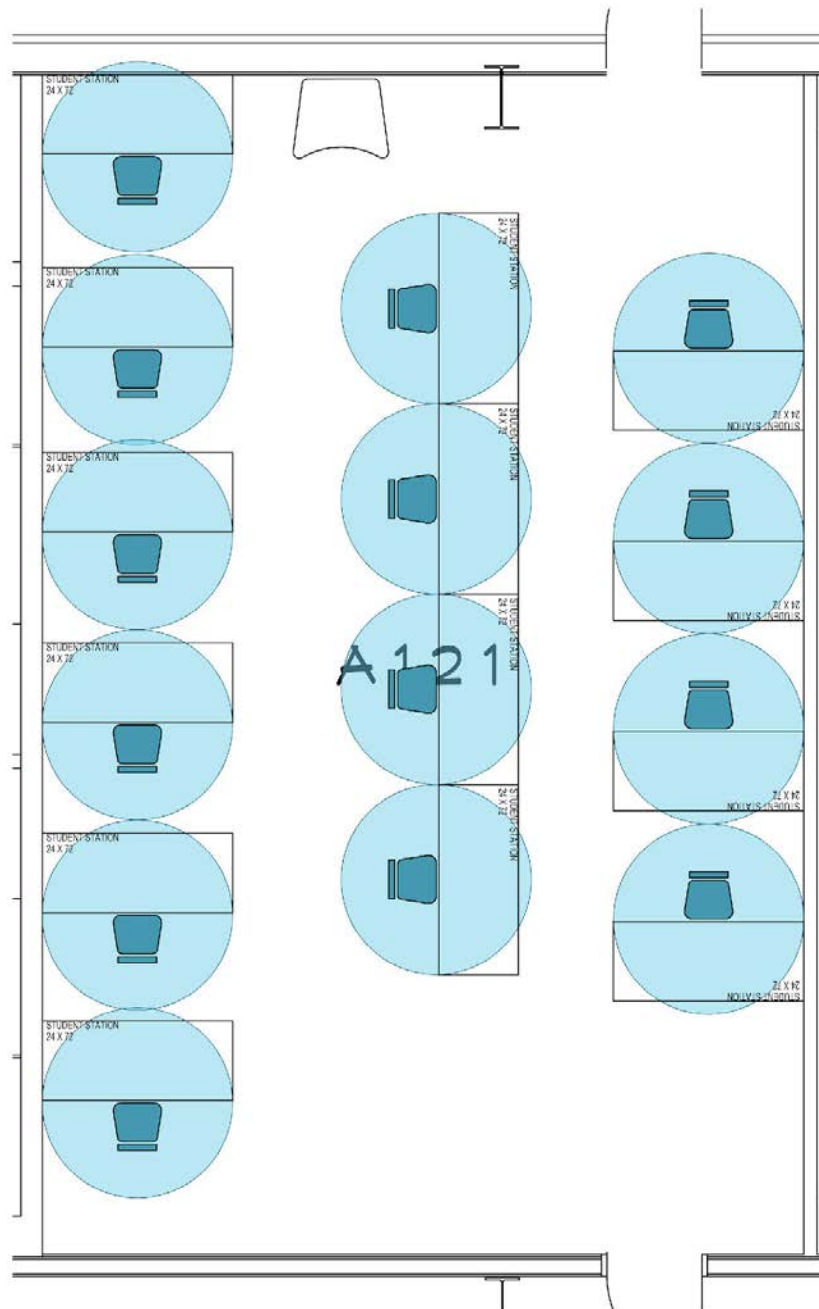

Aviation Technology Program
A123

Classroom Layout	Number of students
Class A (Blue)	24 students

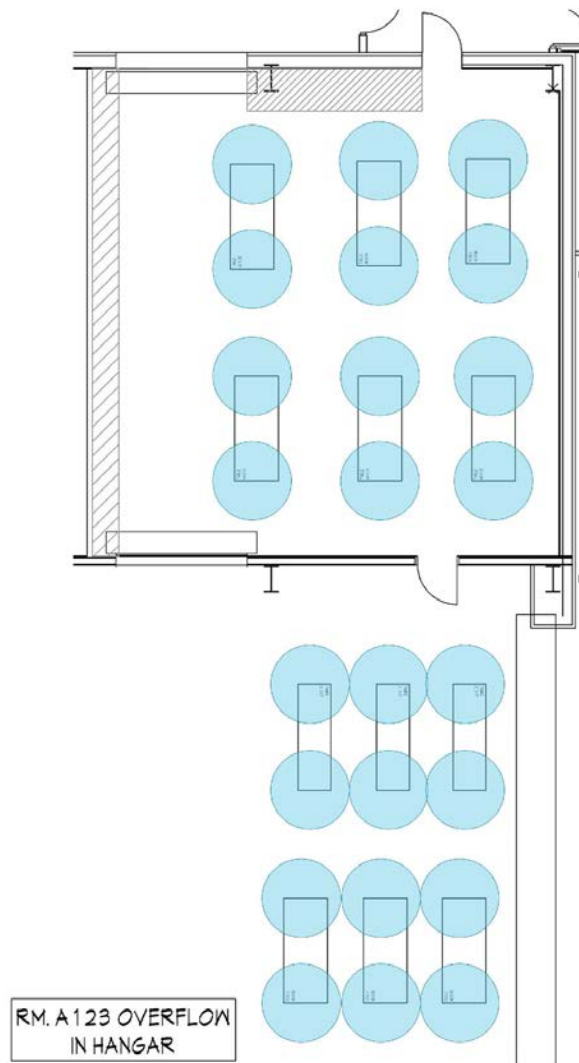

Aviation Technology Program
A124

Classroom Layout	Number of students
Class A (Blue)	18 students

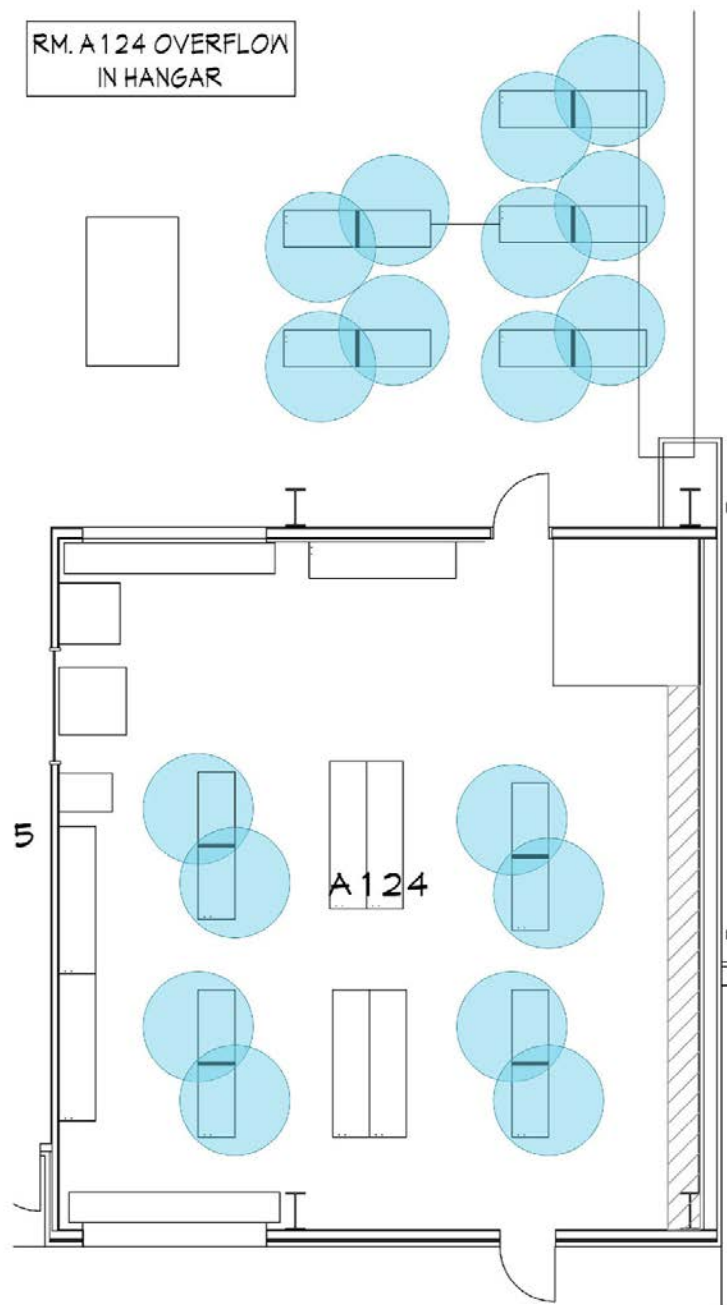

Aviation Technology Program
A128

Classroom Layout	Number of students
Class A (Blue)	12 students
Class B (Red)	12 students

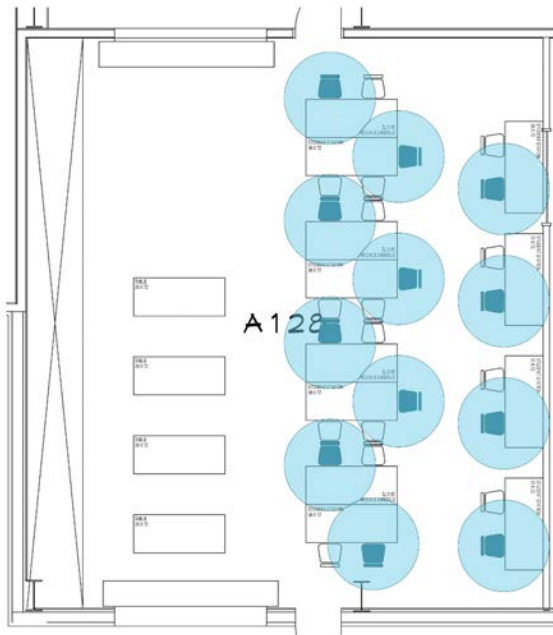

Aviation Technology Program
A140

Classroom Layout	Number of students
Class A (Blue)	12 students
Class B (Red)	12 students

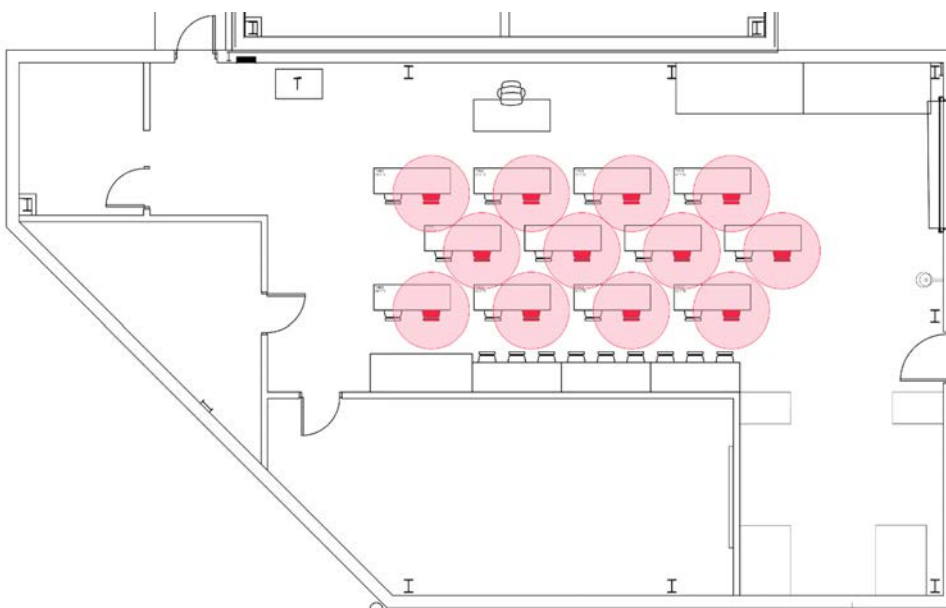
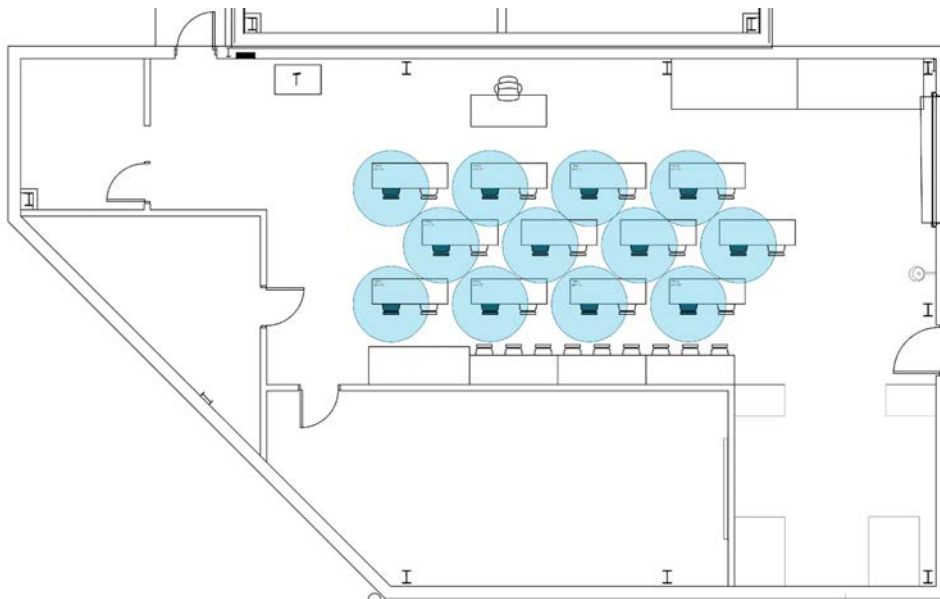

East Campus

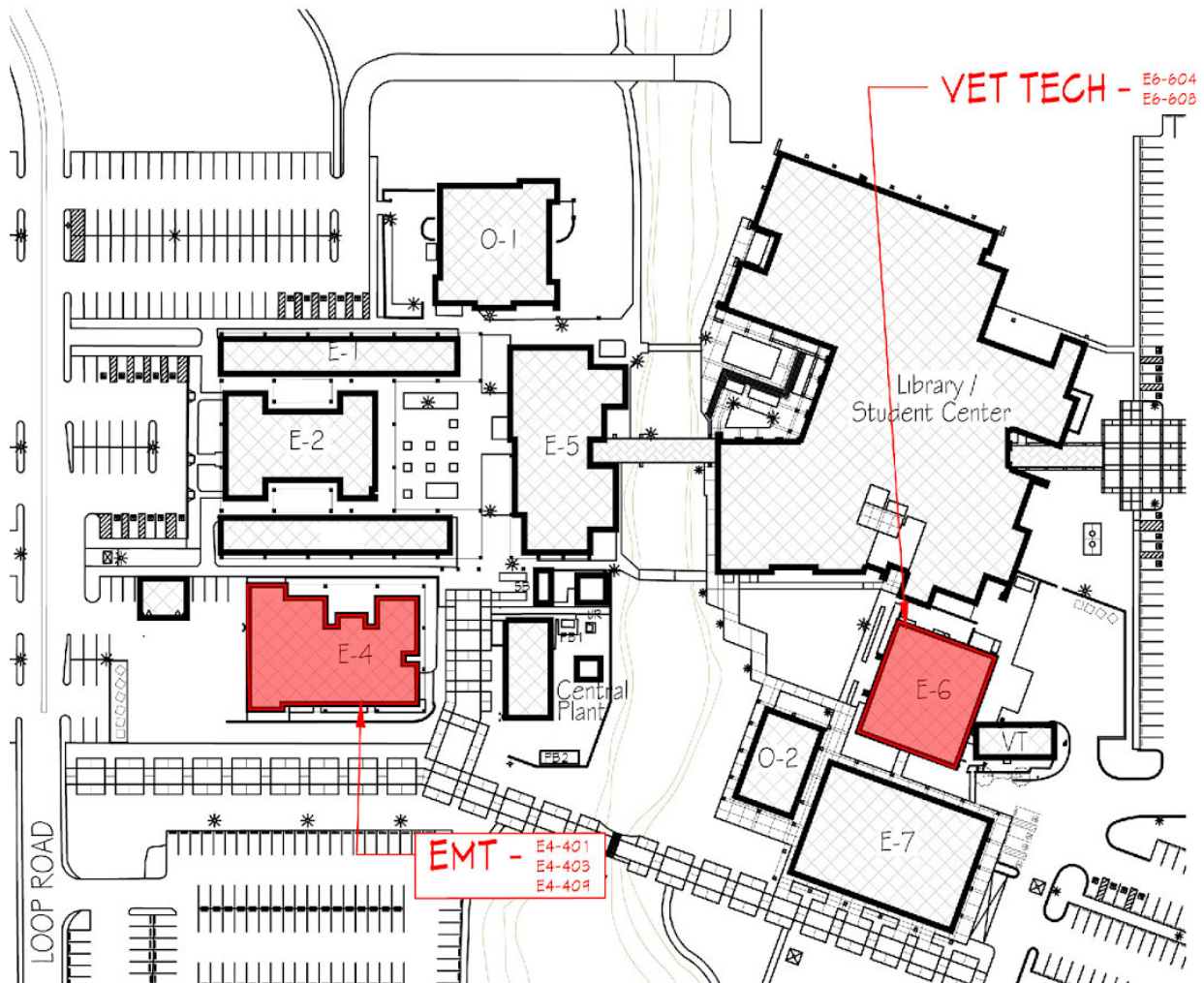

Emergency Medical Technology Program

E4-401

Classroom Layout	Number of students
Class A (Blue)	12 students
Class B (Red)	12 students

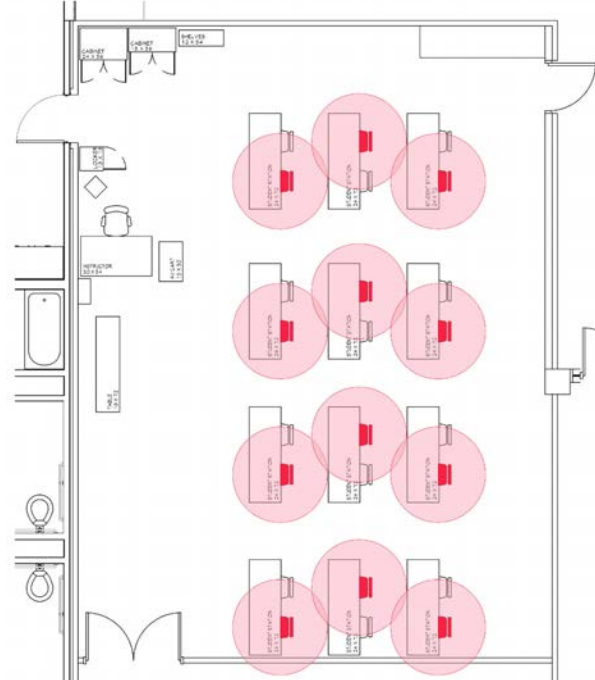
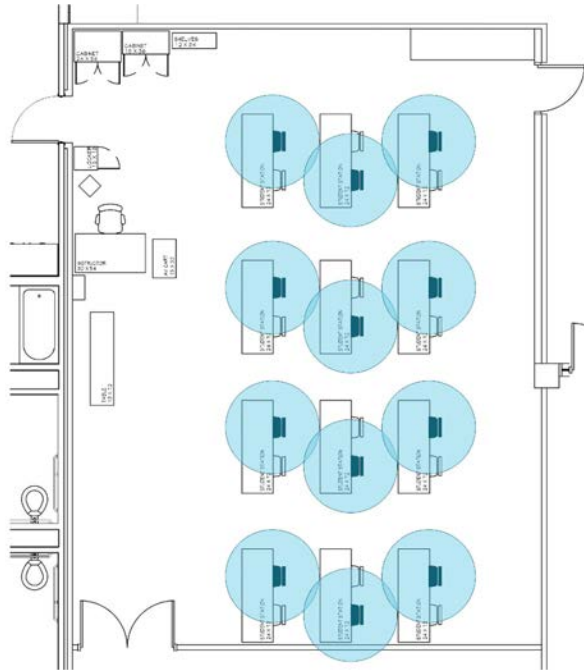

Emergency Medical Technology Program
E4-403

Classroom Layout	Number of students
Class A (Blue)	14 students
Class B (Red)	14 students
Class C (Orange)	12 students
Class D (Purple)	12 students

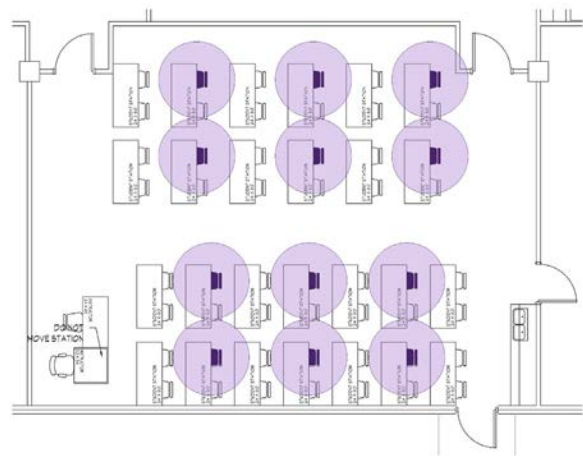
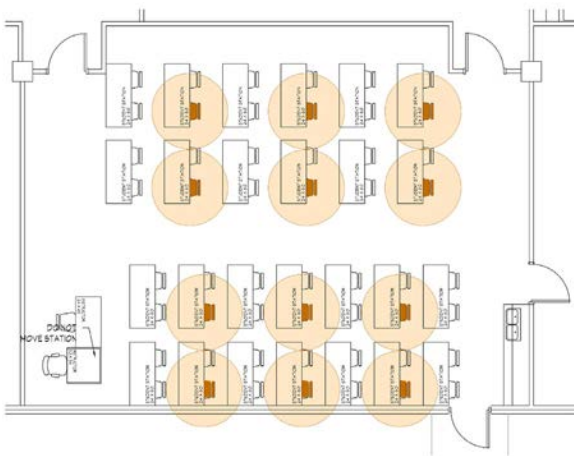
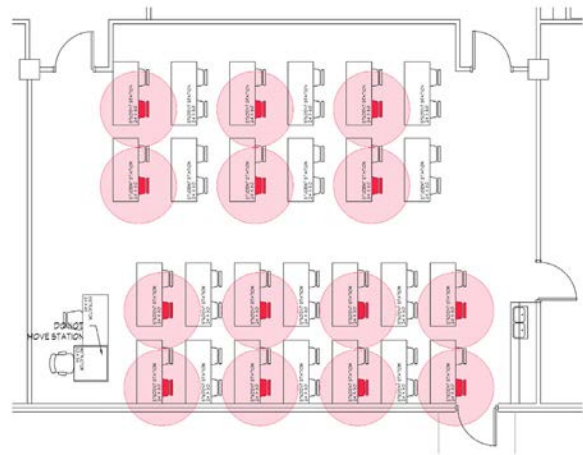
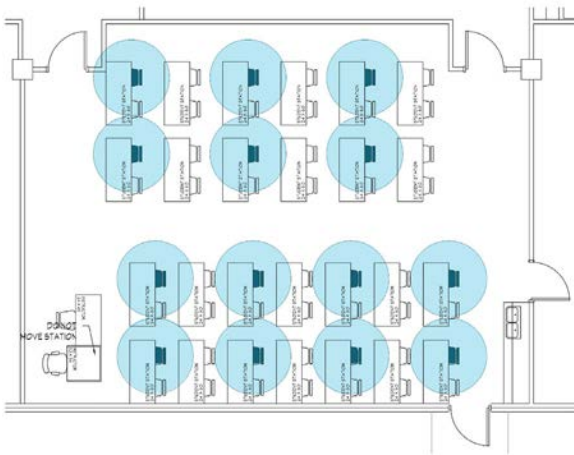

Emergency Medical Technology Program
E4-409

Classroom Layout	Number of students
Class A (Blue)	9 students
Class B (Red)	9 students
Class C (Orange)	9 students
Class D (Purple)	7 students

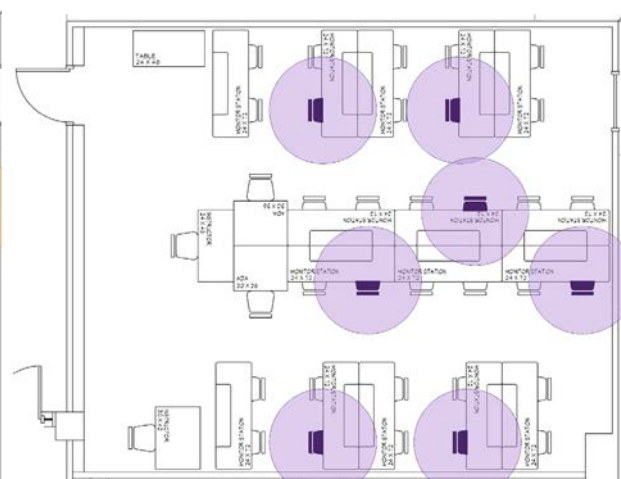
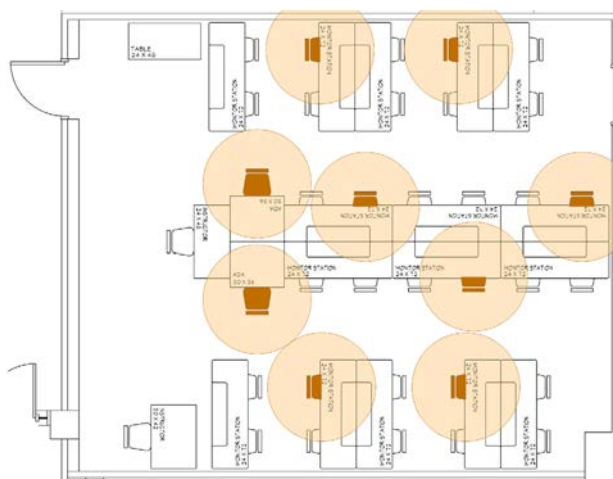
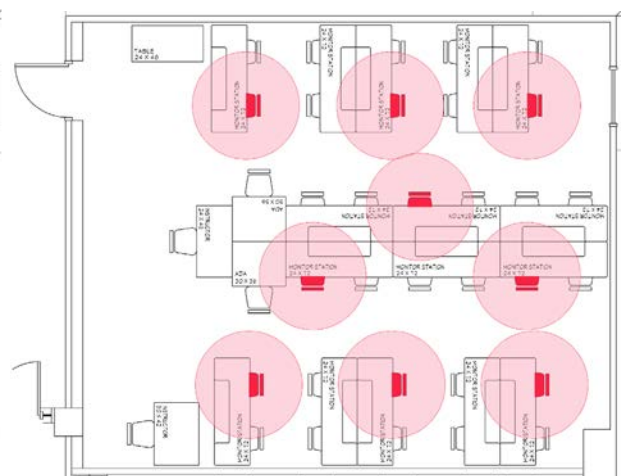
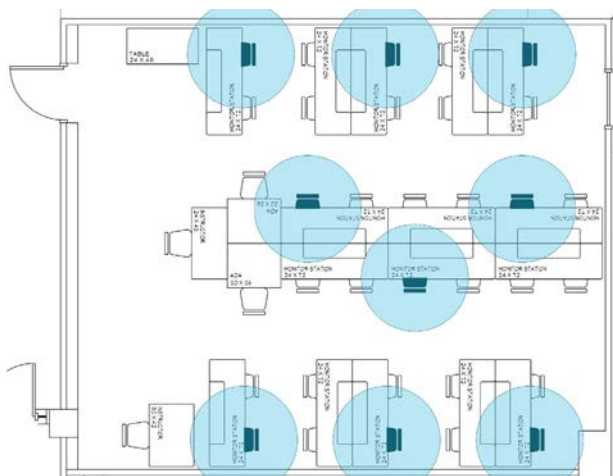

Veterinary Technology Program

E6-604

Classroom Layout	Number of students
Class A (Blue)	9 students
Class B (Red)	9 students
Class C (Orange)	6 students



Veterinary Technology Program
E6-608

Classroom Layout	Number of students
Class A (Blue)	9 students
Class B (Red)	9 students
Class C (Orange)	8 students

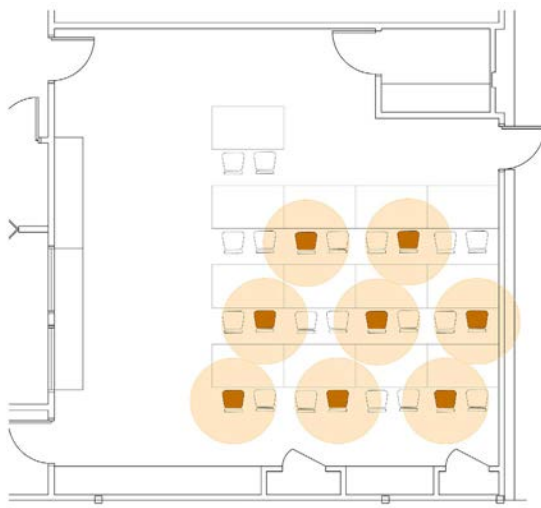
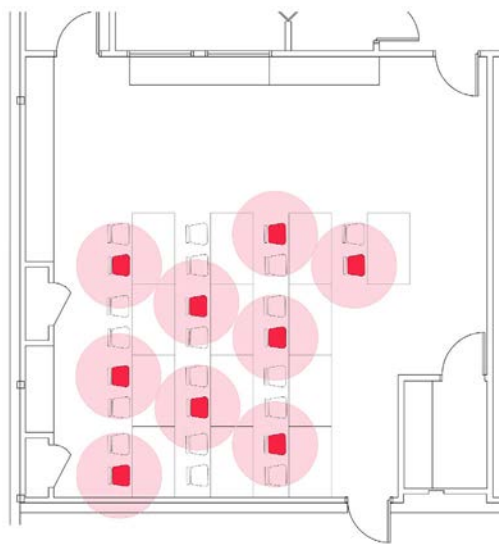

Veterinary Technology Program
E7-704

Classroom Layout	Number of students
Class A (Blue)	9 students
Class B (Red)	9 students

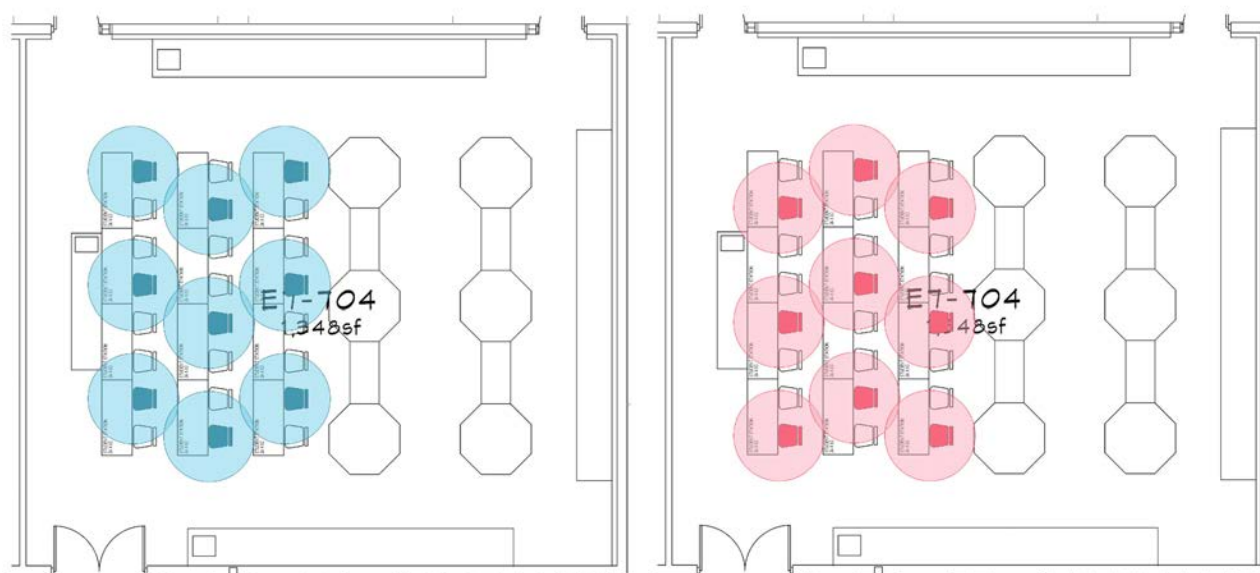

PCC Facilities

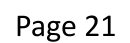

Radiologic Technology Program

HG06

Classroom Layout	Number of students
Class A (Blue)	8 students
Class B (Red)	8 students
Class C (Orange)	8 students
Class D (Purple)	8 students

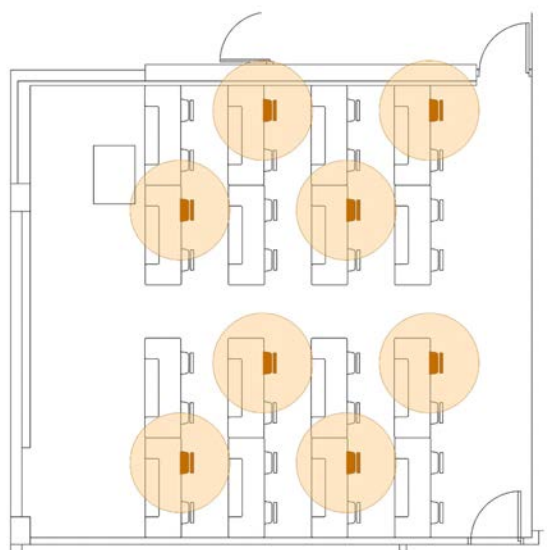
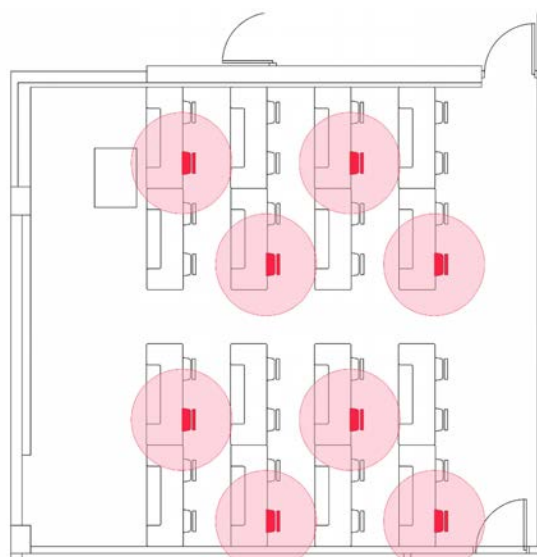
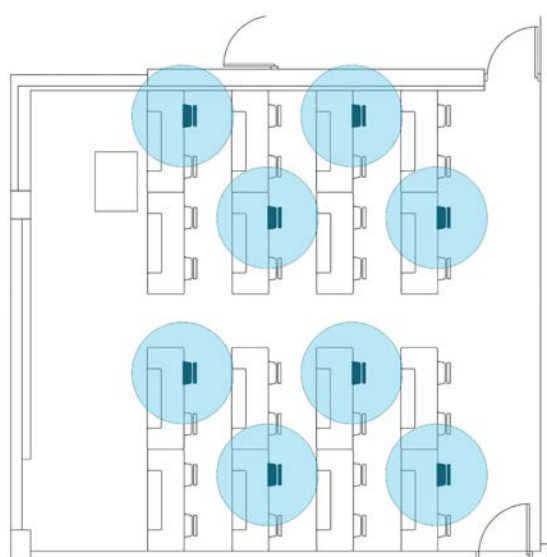

Radiology Technology Program
HG07

Classroom Layout	Number of students
Class A (Blue)	6 students
Class B (Red)	6 students

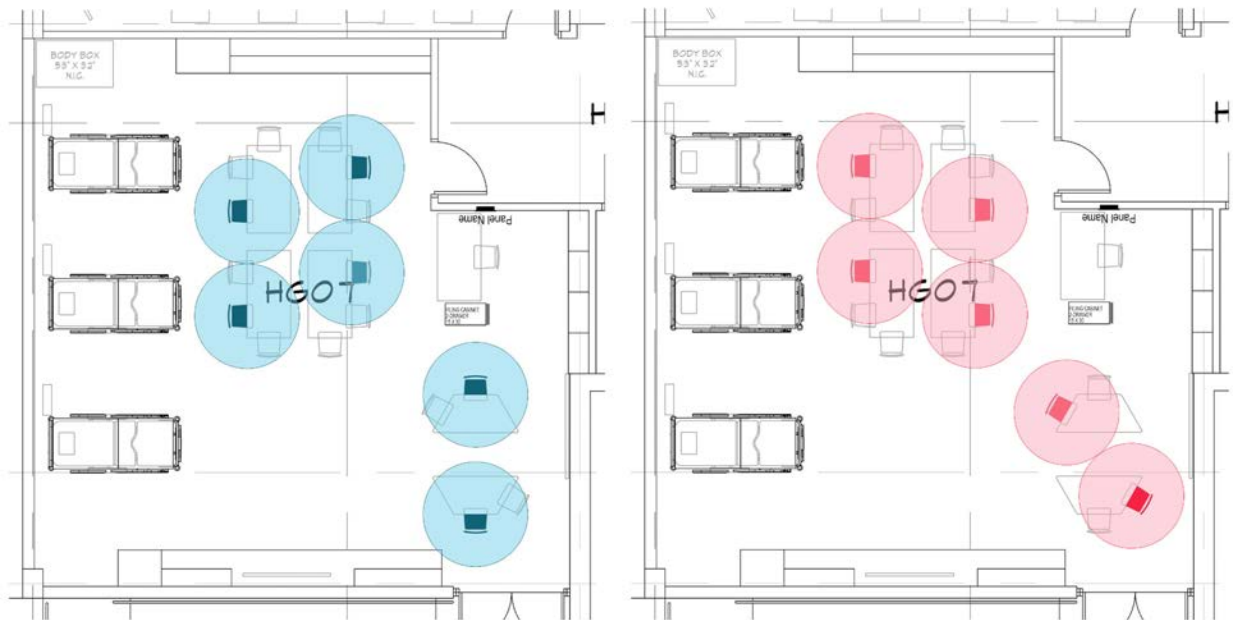

Respiratory Therapy

HG09

Classroom Layout	Number of students
Class A (Blue)	14 students
Class B (Red)	14 students
Class C (Orange)	14 students
Class D (Purple)	14 students

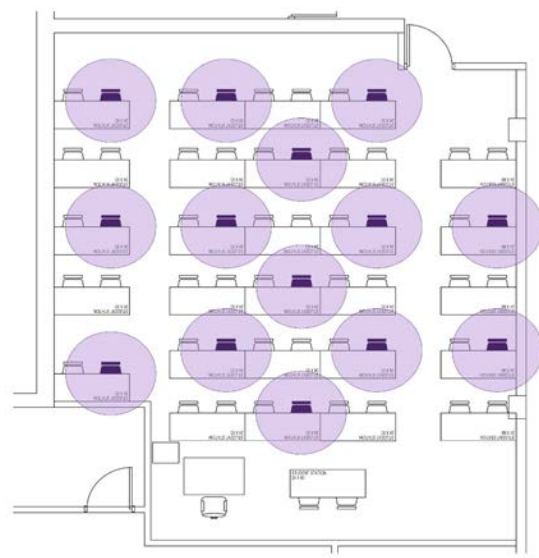
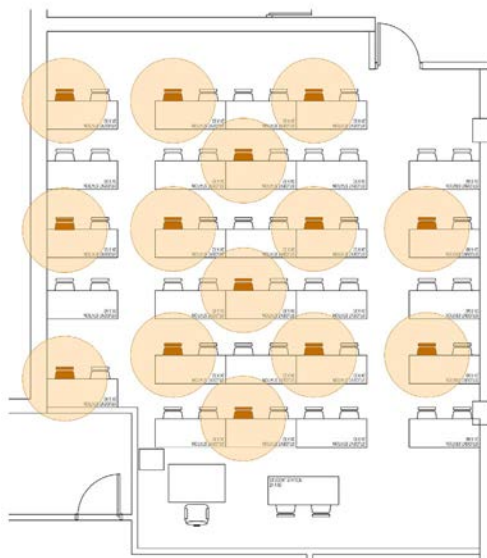
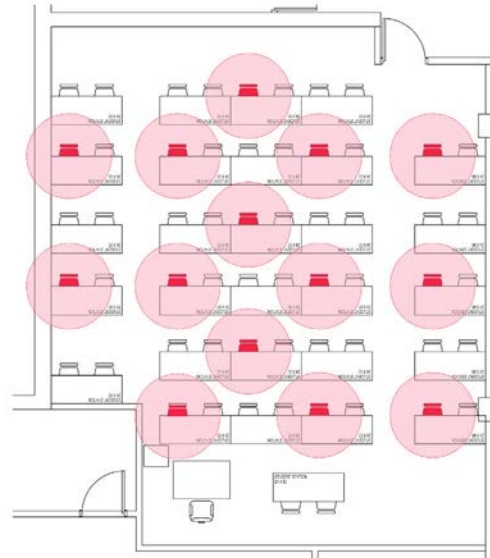
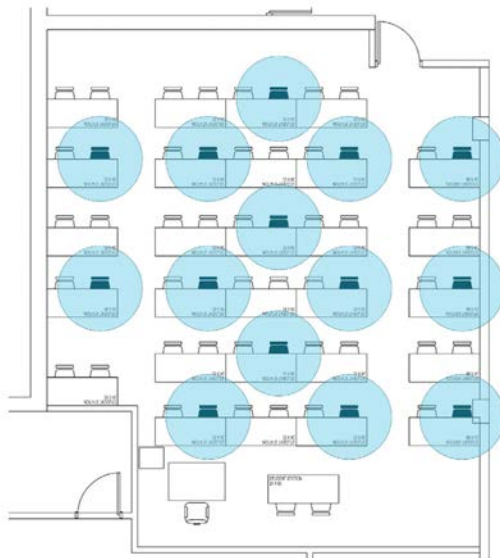

Dental Hygiene Dental Clinic

Classroom Layout	Number of students
Class A (Blue)	22 students

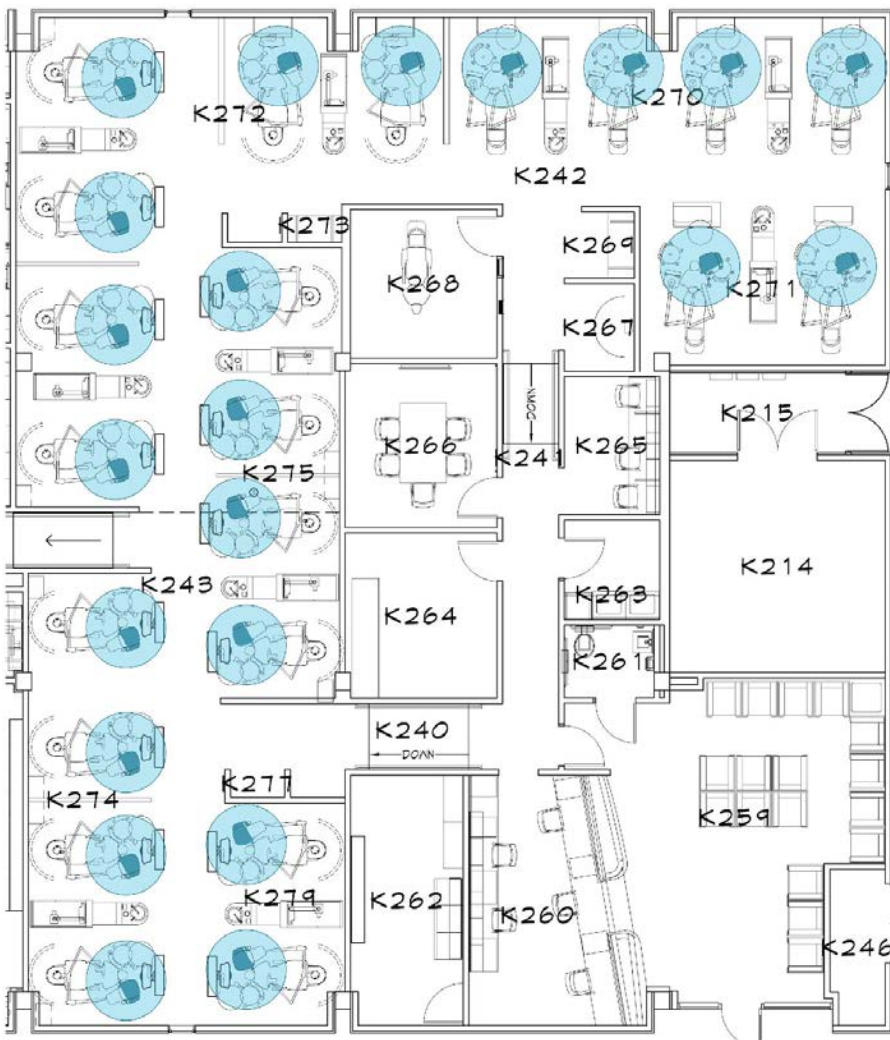

Medical Lab Technician K136

Classroom Layout	Number of students
Class A (Blue)	10 students
Class B (Red)	10 students

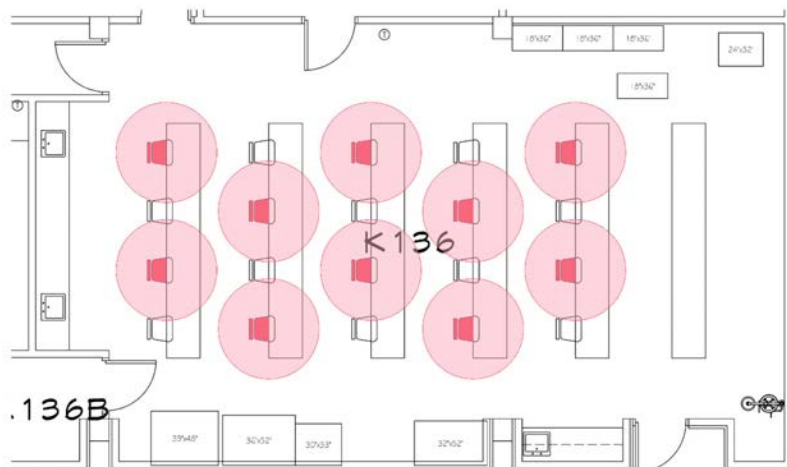
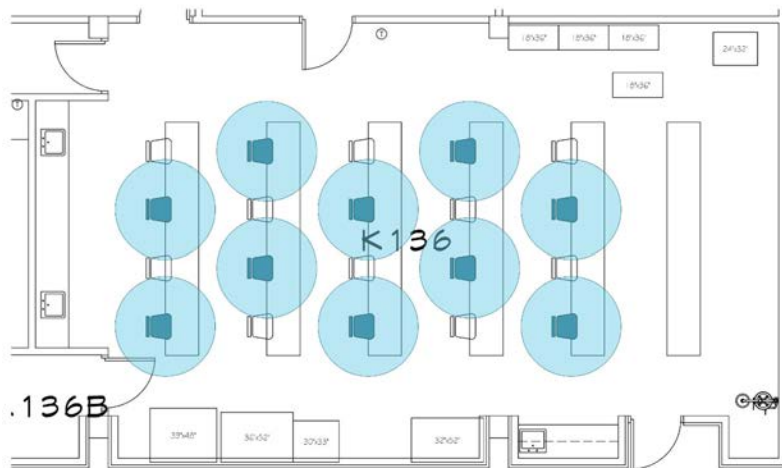

Dental Lab Technician

K209

Classroom Layout	Number of students
Class A (Blue)	8 students
Class B (Red)	7 students

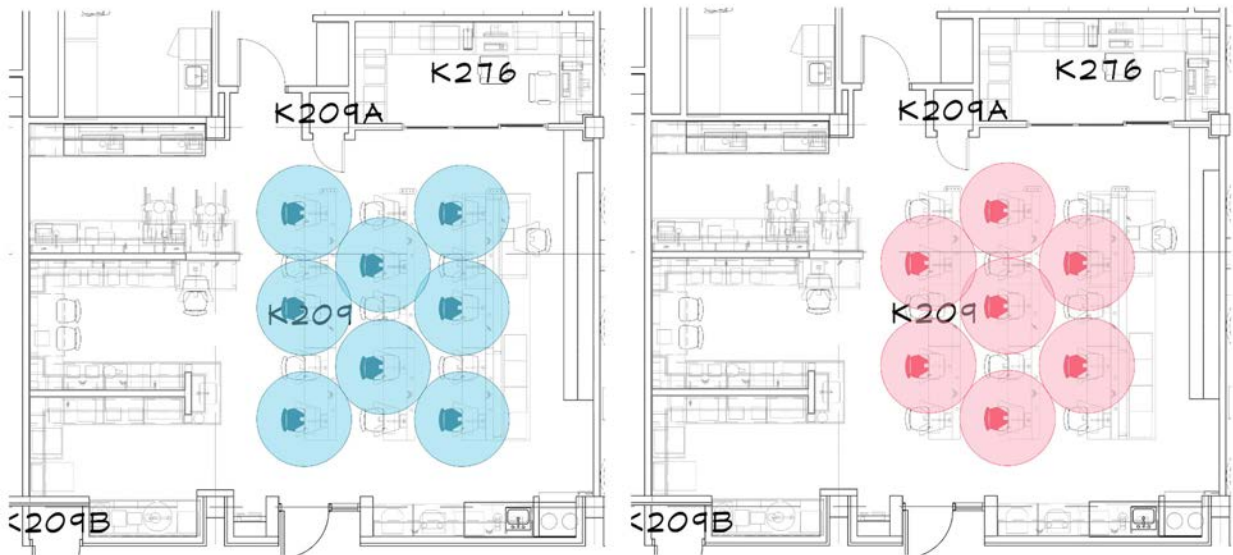

Wave 2

Courses described below:

Open Date	Location	Areas	Program
6/15/2020	29th Street	A Building	Paramedic
6/15/2020	29th Street	A Building	Law & SALETC
6/15/2020	DV	Pueblo Building	Licensed Practical Nurse
6/15/2020	DV	Pueblo Building	Nursing Assistant
6/15/2020	DV	Pueblo Building	Medical Assistant
6/15/2020	DV	E Building	Surgical Tech
6/15/2020	WC	C Building	Digital Arts
6/15/2020	MS	Truck Driving	Truck Driving
6/15/2020	DC	ST Building	Automotive

29th Street Coalition Center

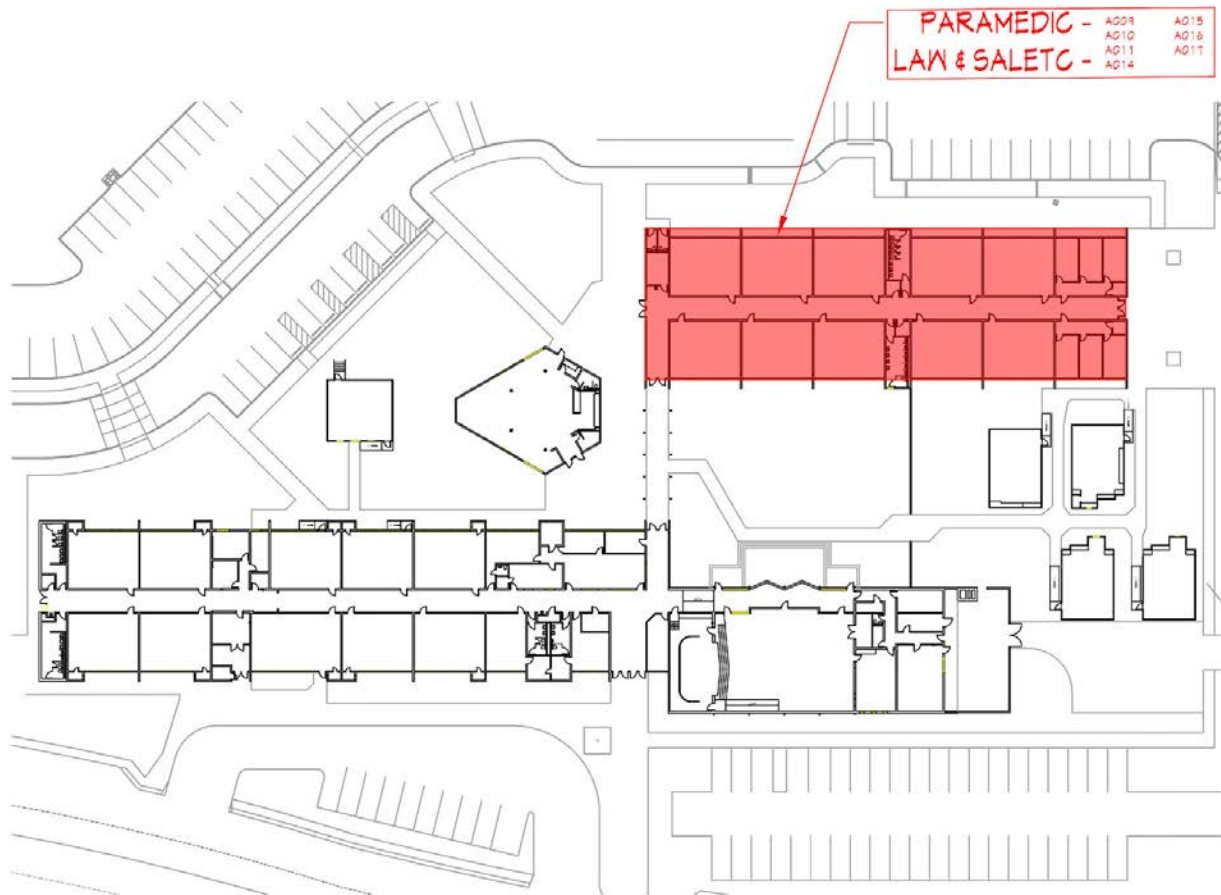

Paramedic A008

Classroom Layout	Number of students
Class A (Blue)	10 students

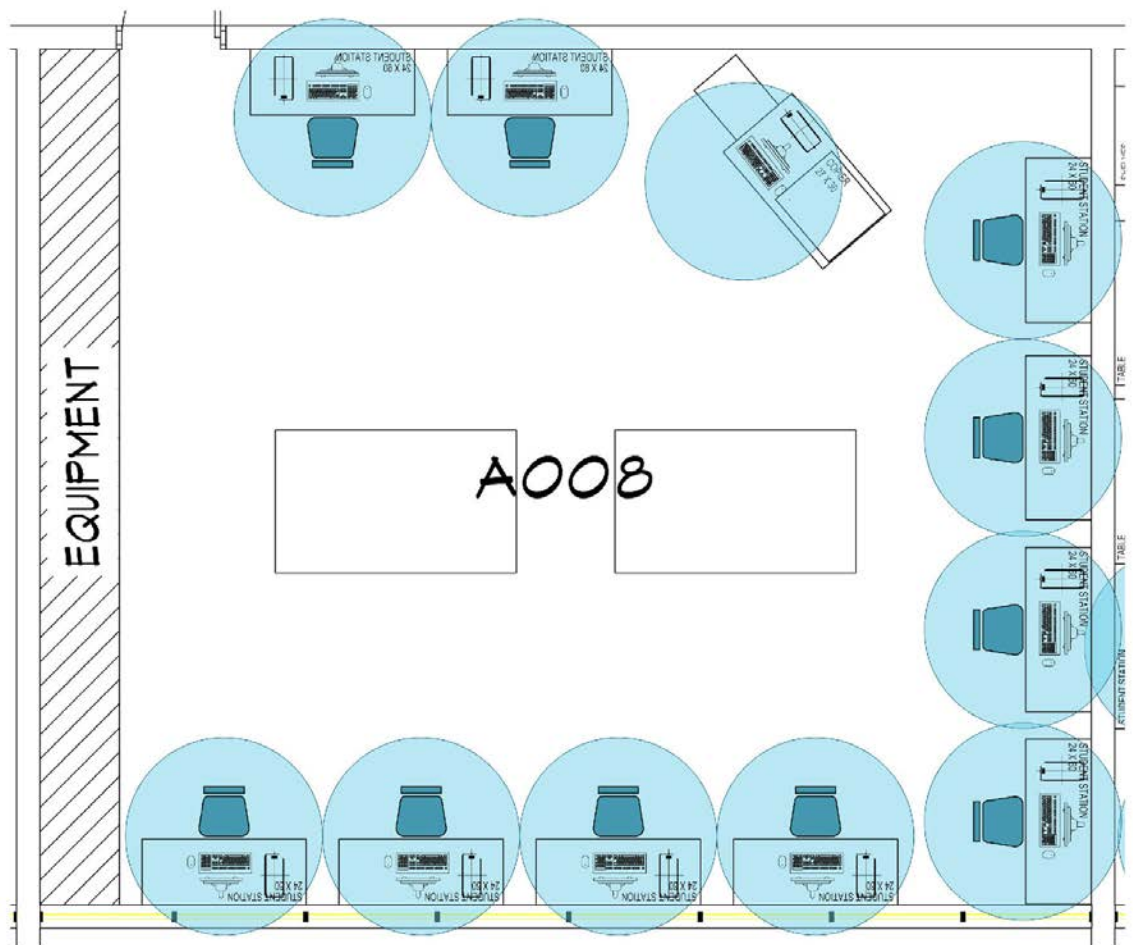

Paramedic
A009

Classroom Layout	Number of students
Class A (Blue)	6 students

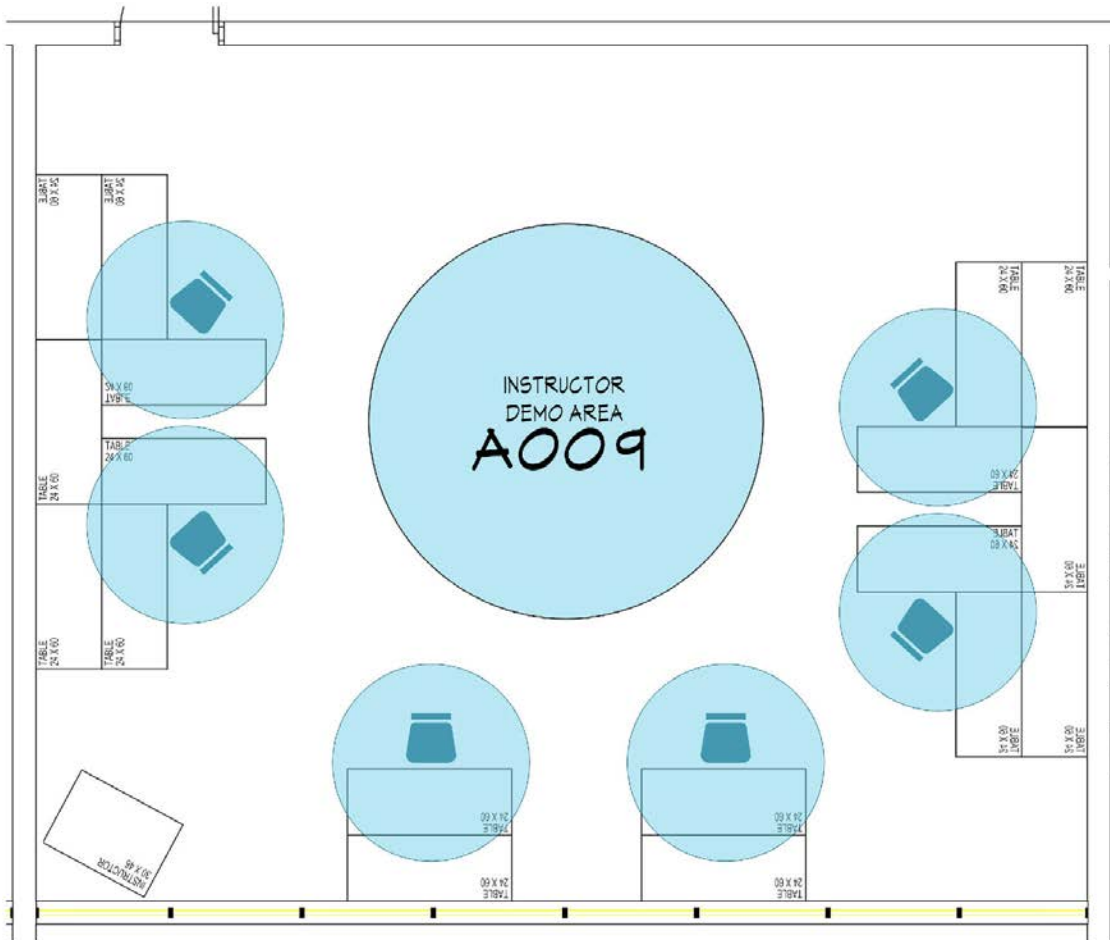

Paramedic
A010

Classroom Layout	Number of students
Class A (Blue)	6 students

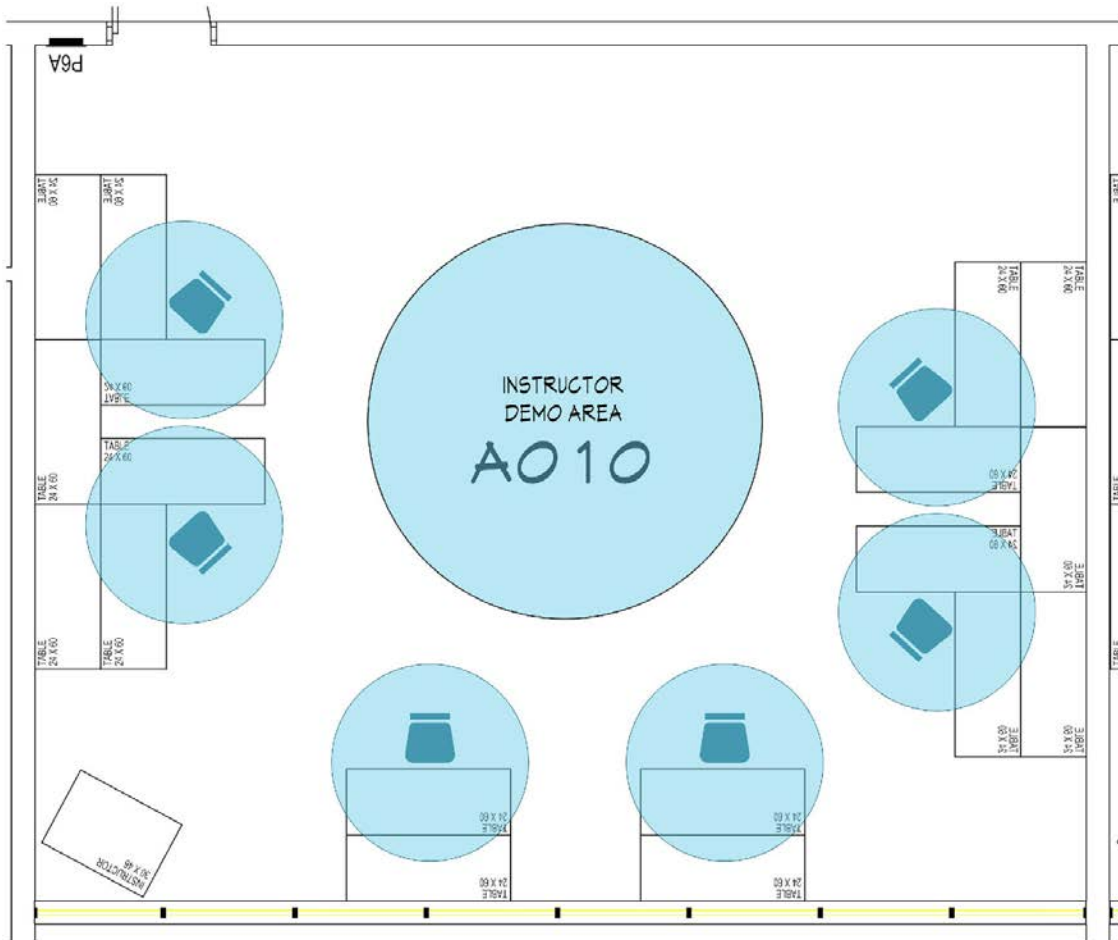

Paramedic
A011

Classroom Layout	Number of students
Class A (Blue)	6 students

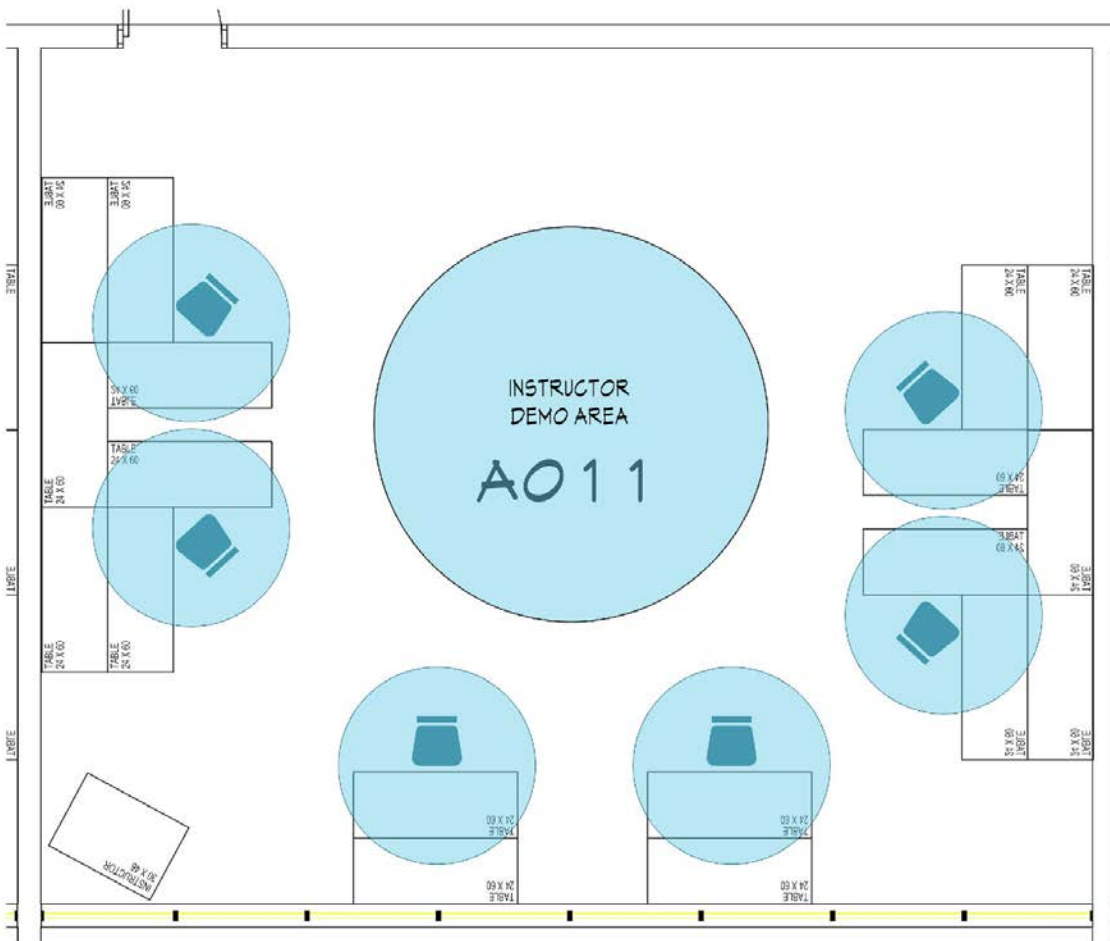

Paramedic
A014

Classroom Layout	Number of students
Class A (Blue)	8 students

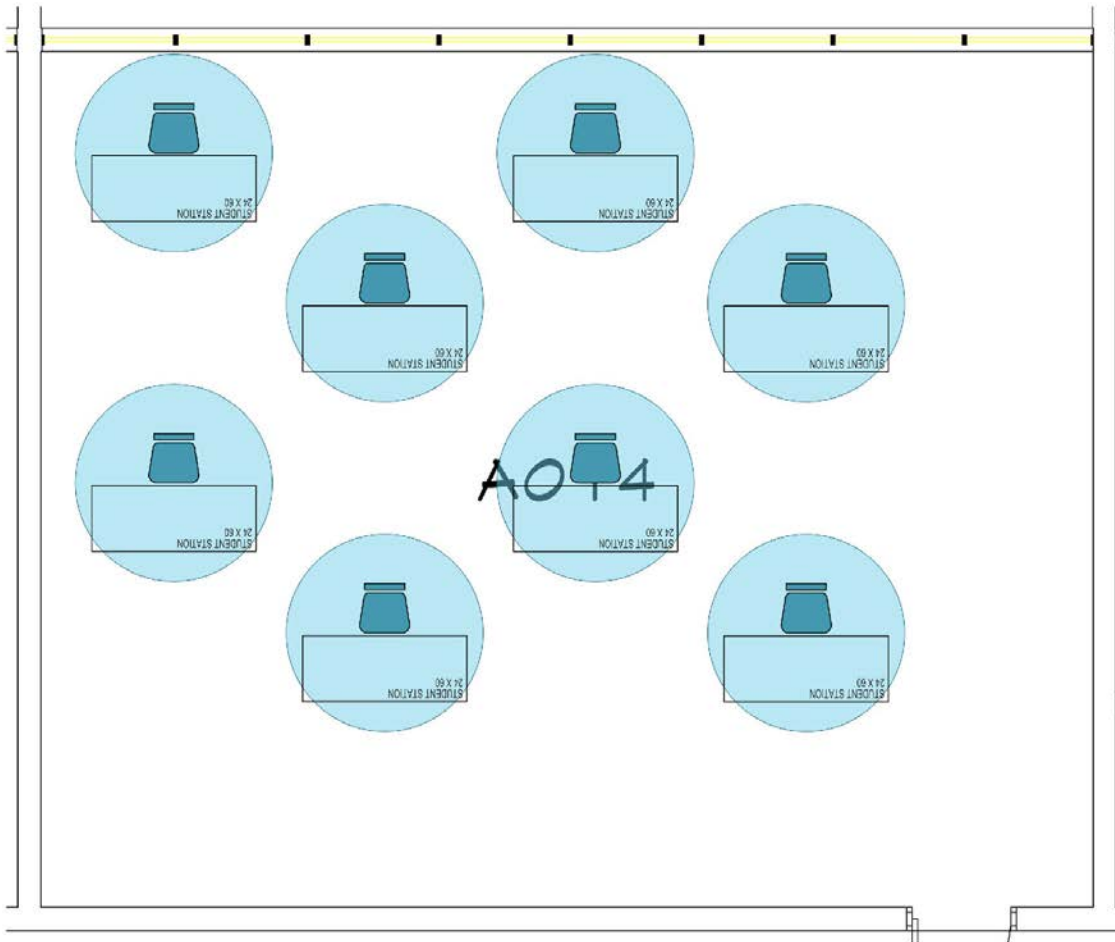

Paramedic
A016

Classroom Layout	Number of students
Class A (Blue)	8 students

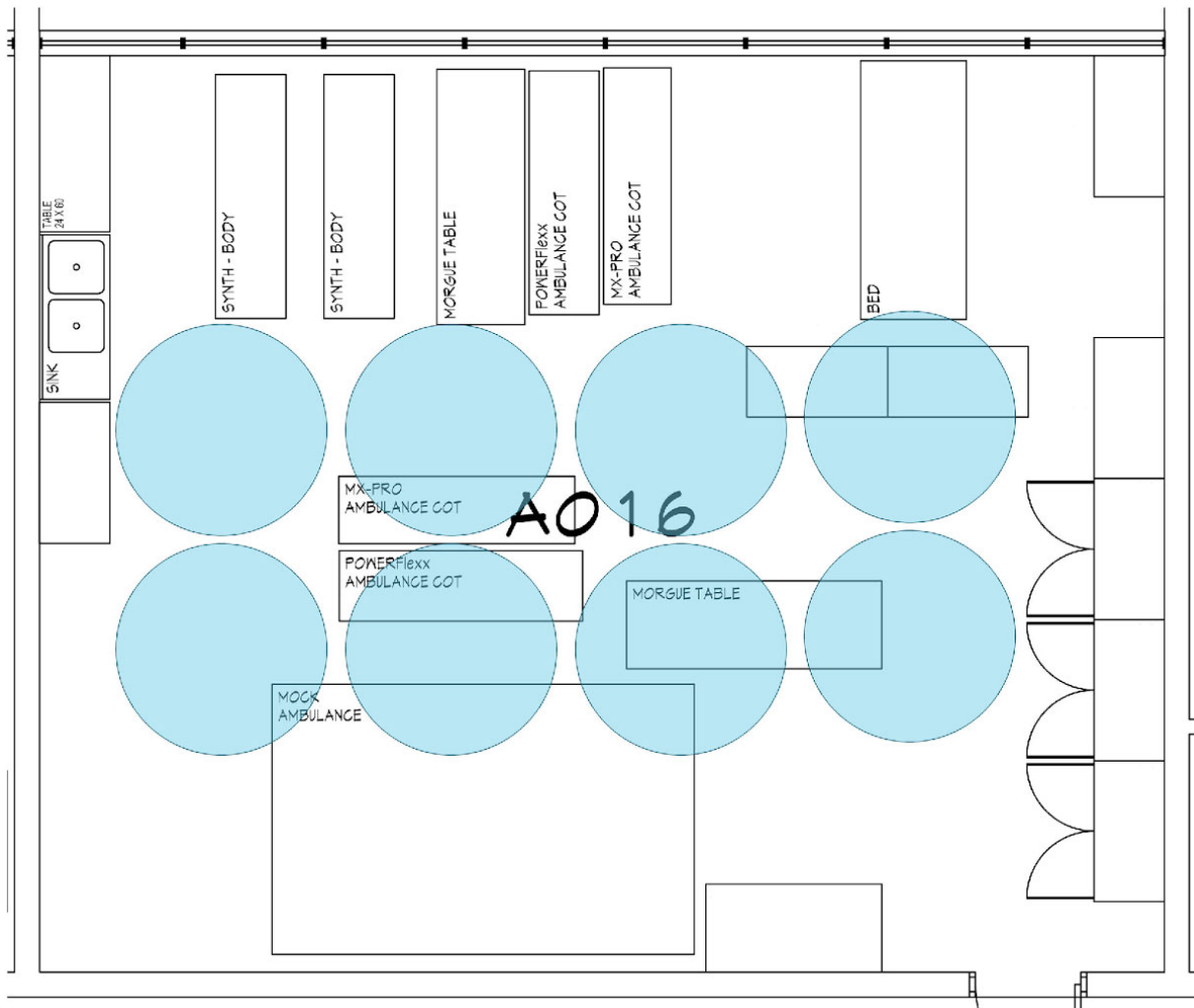

Law & SALTEC A015

Classroom Layout	Number of students
Class A (Blue)	8 students

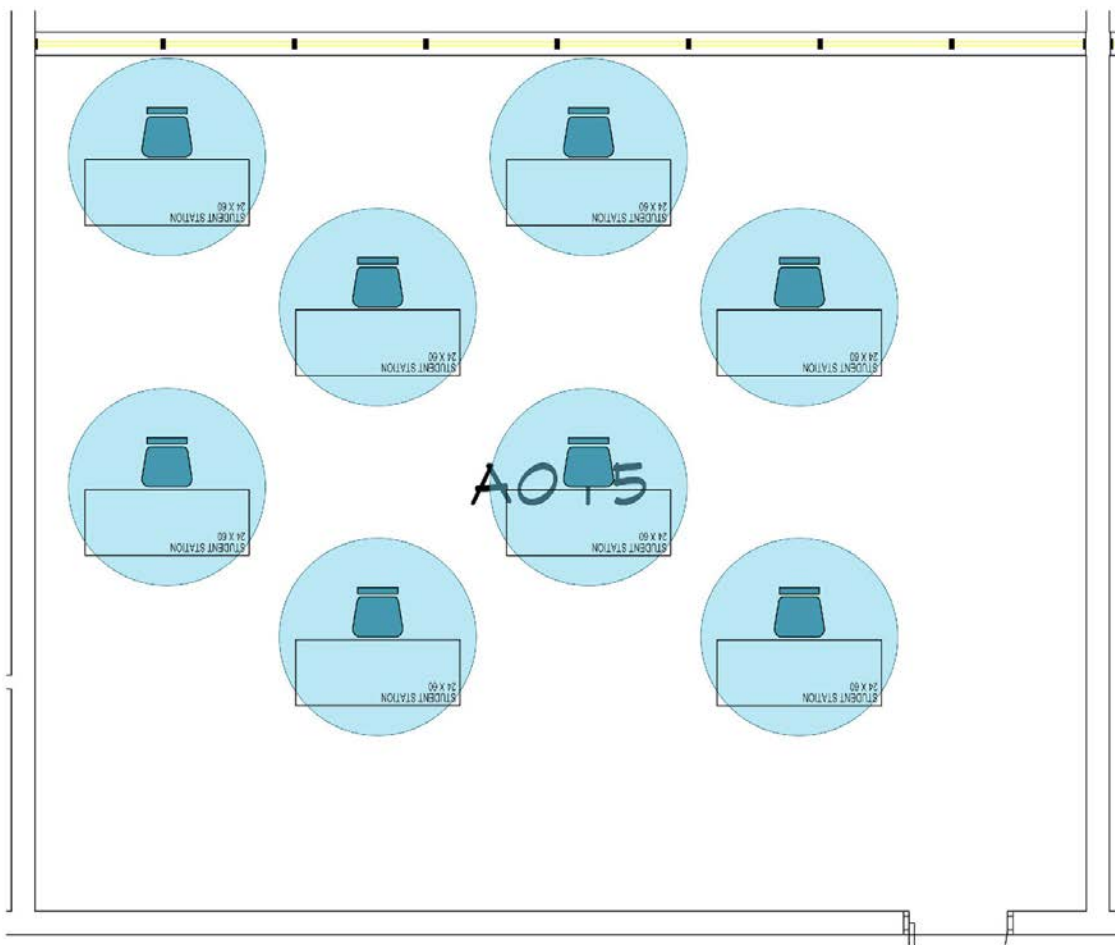

Law & SALTEC
A017

Classroom Layout	Number of students
Class A (Blue)	8 students
Class B (Red)	8 students
Class C (Orange)	8 students
Class D (Purple)	8 students

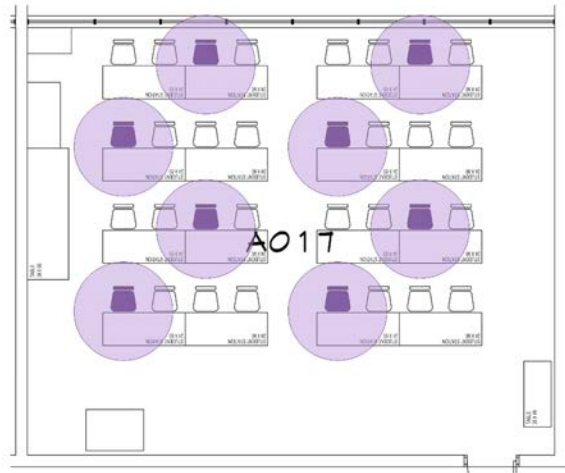

Desert Vista

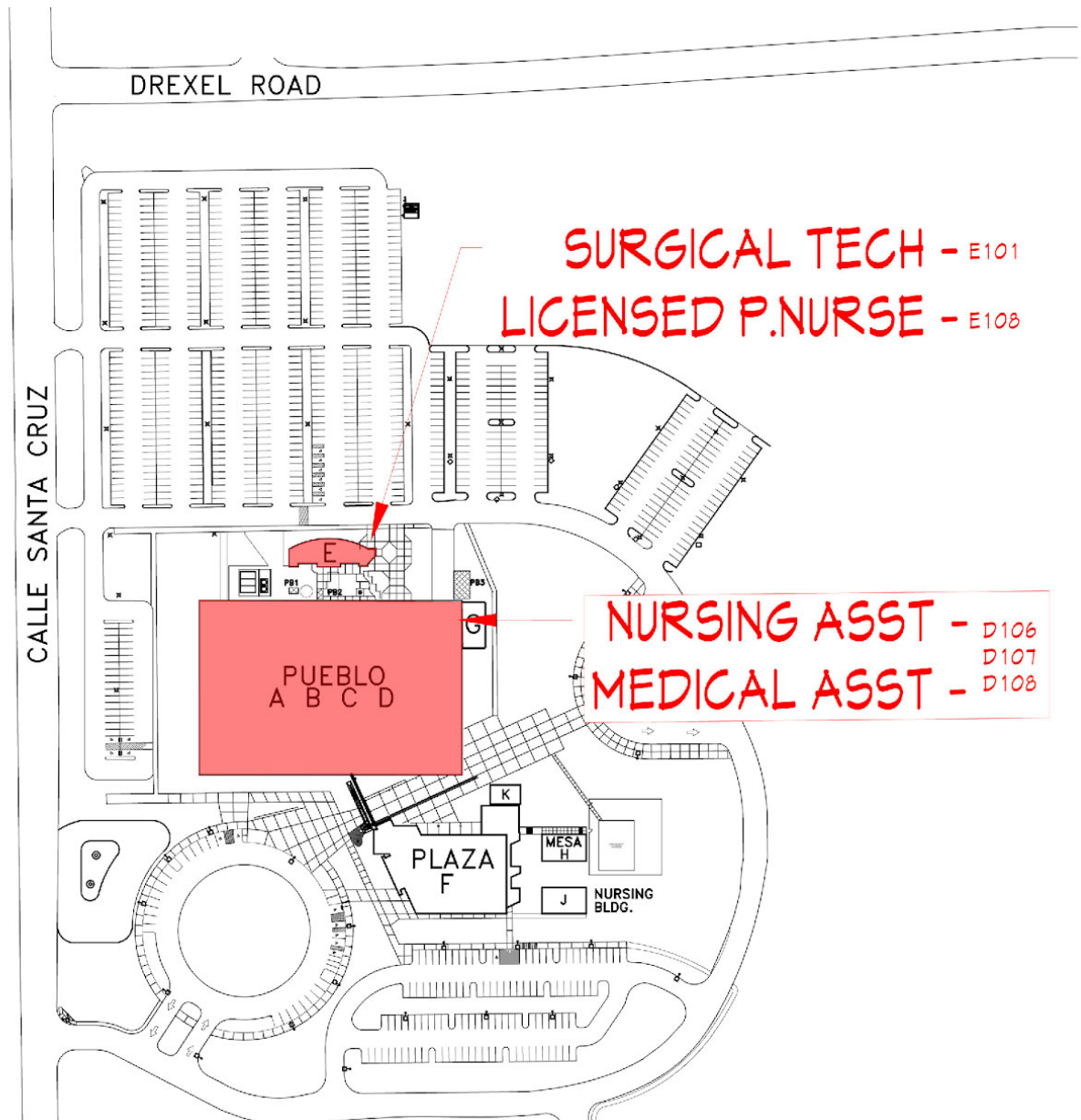

Licensed Practical Nurse (LPN) E108

Classroom Layout	Number of students
Class A (Blue)	4 students

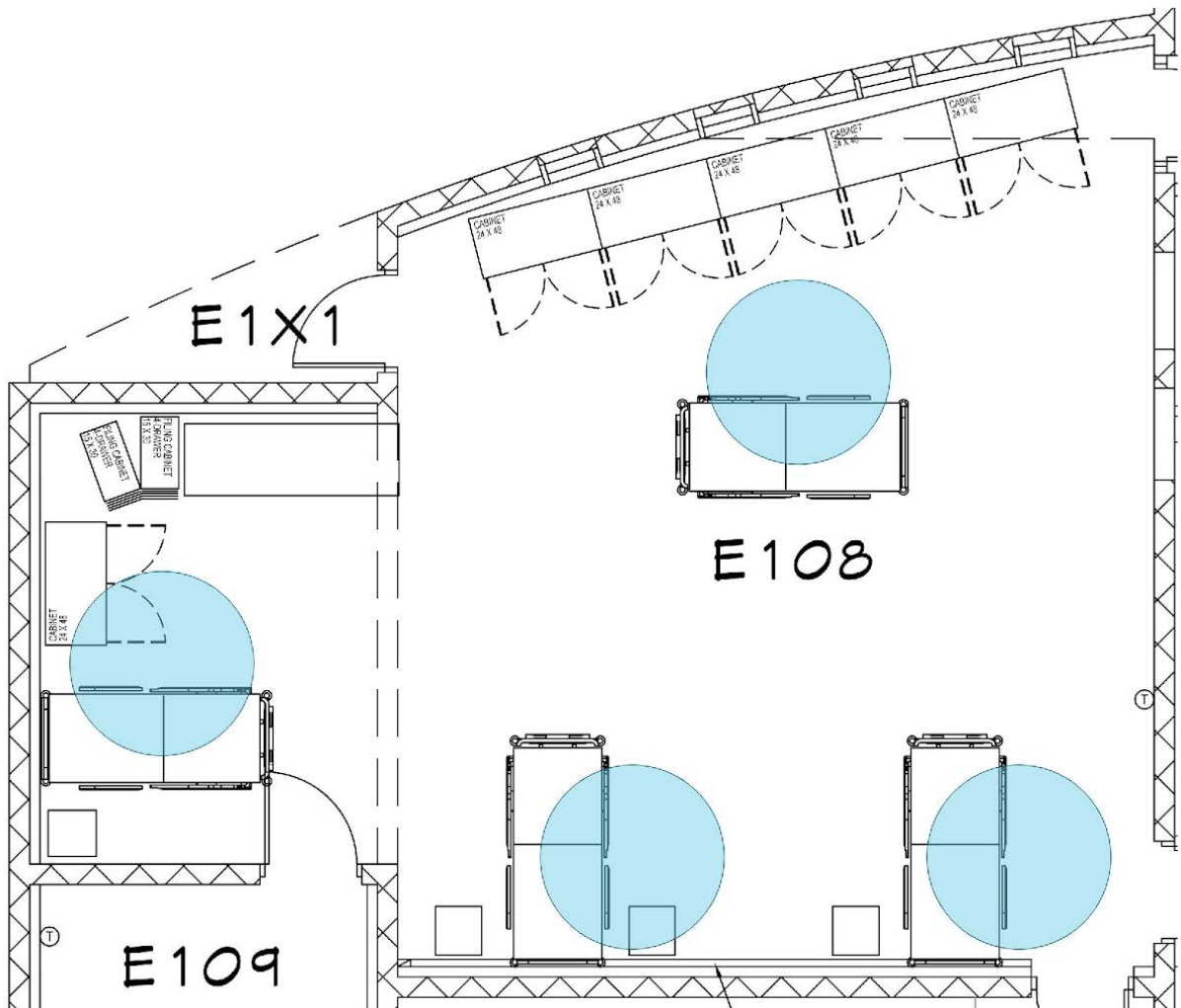

Medical Assistant D106

Classroom Layout	Number of students
Option 1	6 students
Option 2	3 students

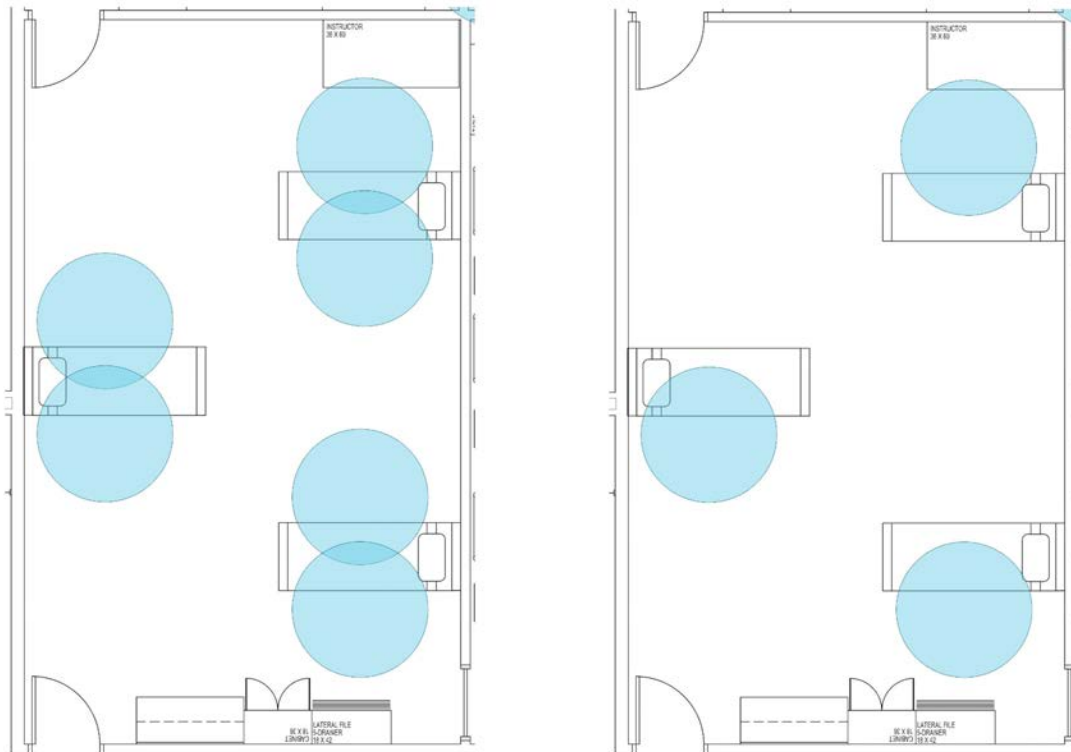

*Option 1 - Pending approval. If not approved, see option 2.

Medical Assistant
D107

Classroom Layout	Number of students
Class A (Blue)	5 students
Class B (Red)	4 students

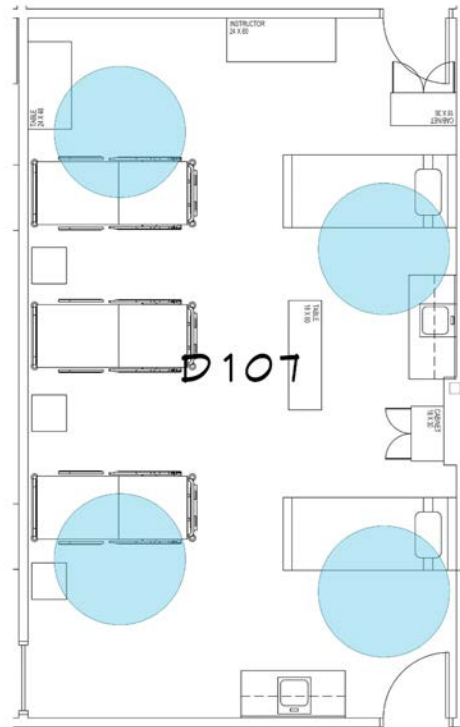
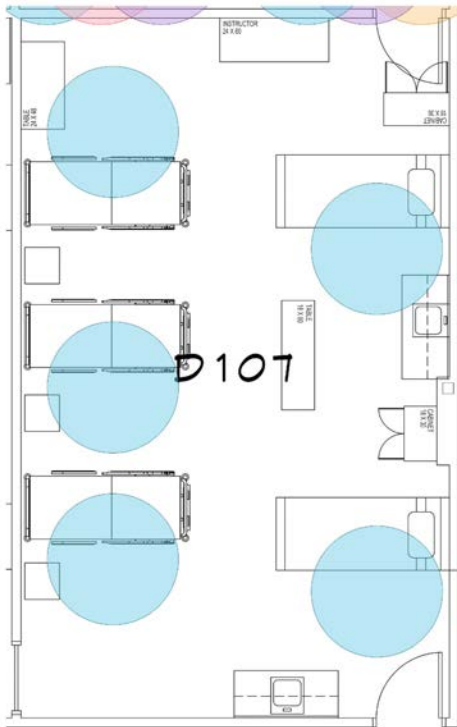

*Option 1 - Pending approval. If not approved, see option 2.

Medical Assistant
D108

Classroom Layout	Number of students
Class A (Blue)	4 students
Class B (Red)	3 students
Class C (Orange)	3 students

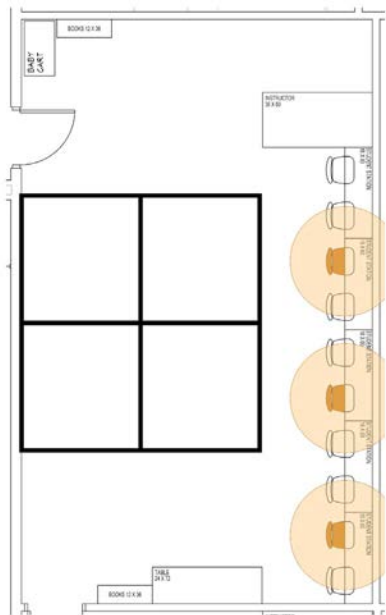
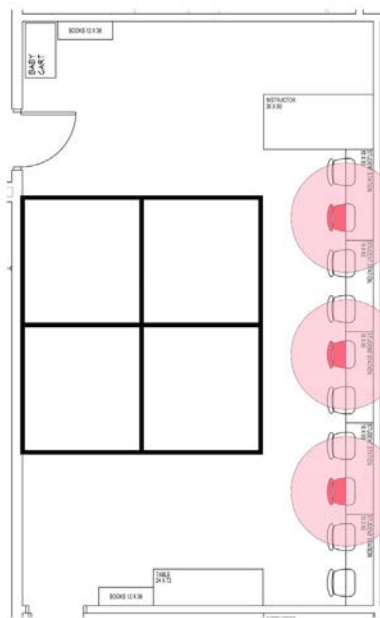
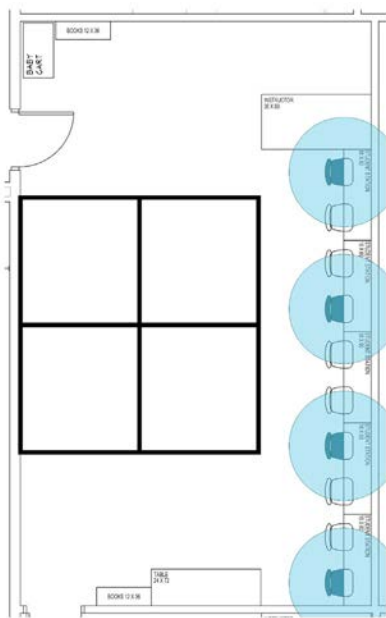

Medical Assistant
D109

Classroom Layout	Number of students
Class A (Blue)	5 students

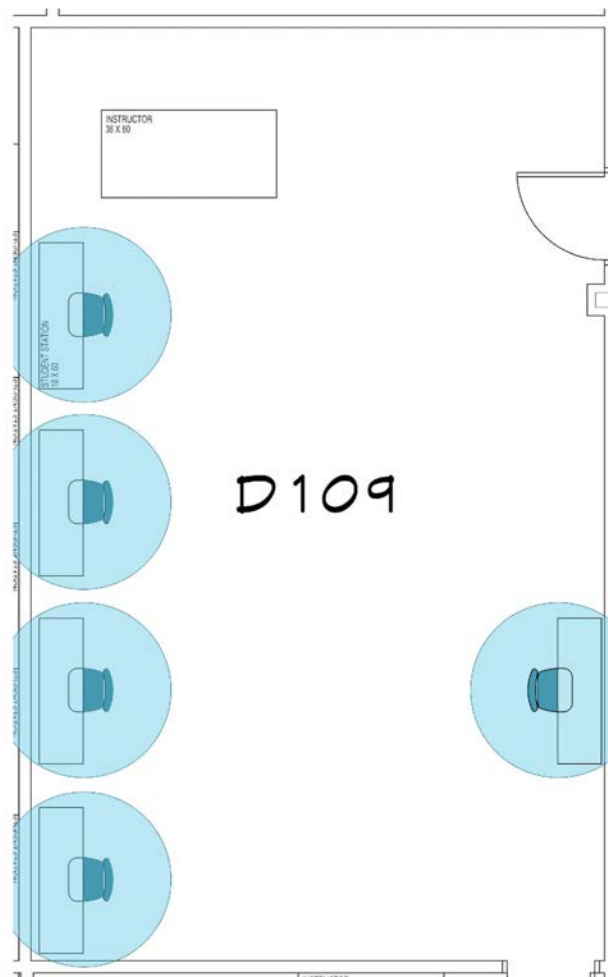

Medical Assistant D118

Classroom Layout	Number of students
Class A (Blue)	8 students
Class B (Red)	8 students
Class C (Orange)	8 students
Class D (Purple)	8 students

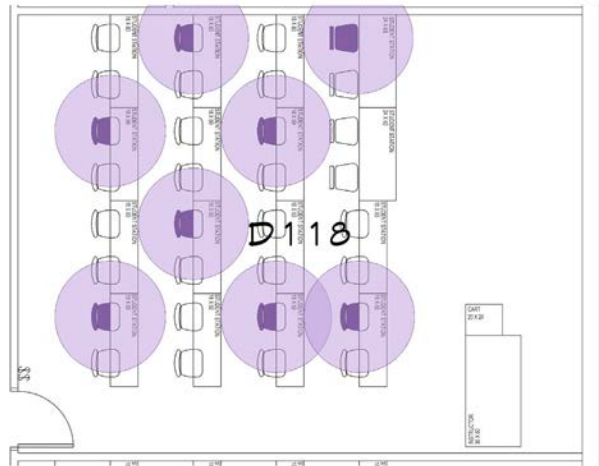
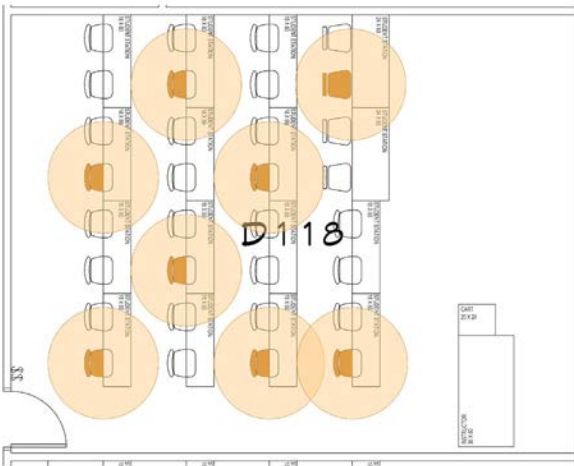

Medical Assistant
D119

Classroom Layout	Number of students
Class A (Blue)	8 students
Class B (Red)	8 students
Class C (Orange)	8 students
Class D (Purple)	8 students

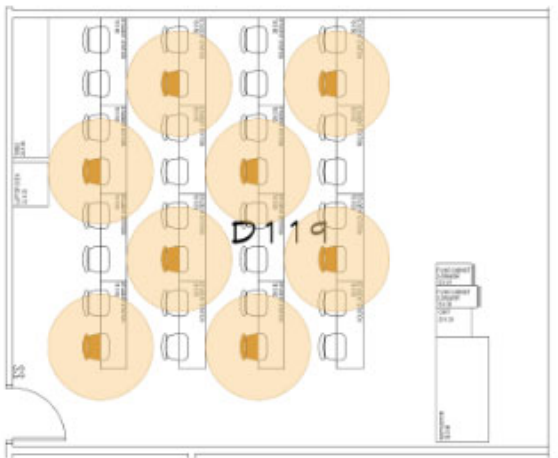

Medical Assistant
B129

Classroom Layout	Number of students
Class A (Blue)	8 students
Class B (Red)	8 students
Class C (Orange)	4 students
Class D (Purple)	4 students

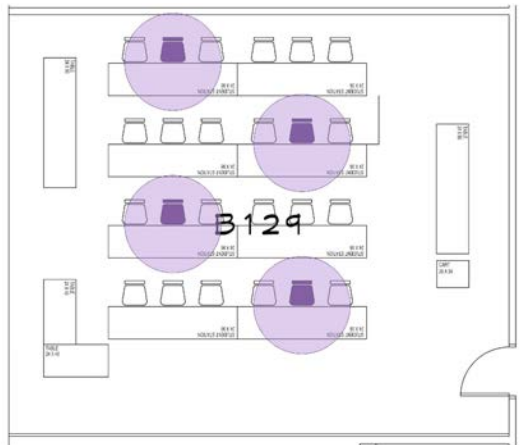
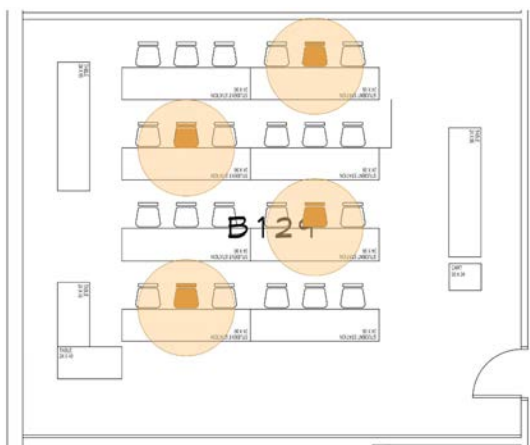
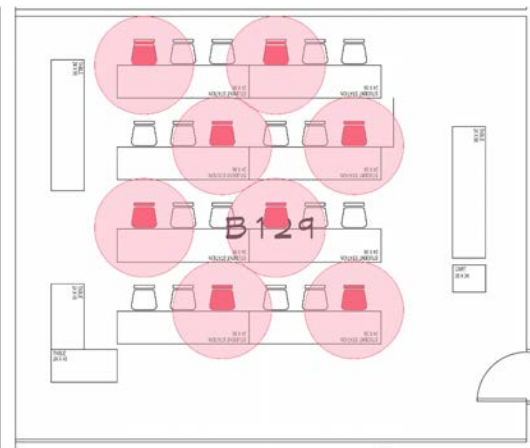
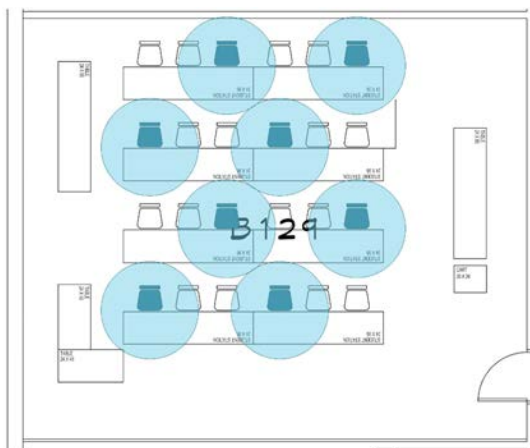

Medical Assistant
B131

Classroom Layout	Number of students
Class A (Blue)	10 students
Class B (Red)	10 students
Class C (Orange)	8 students
Class D (Purple)	10 students

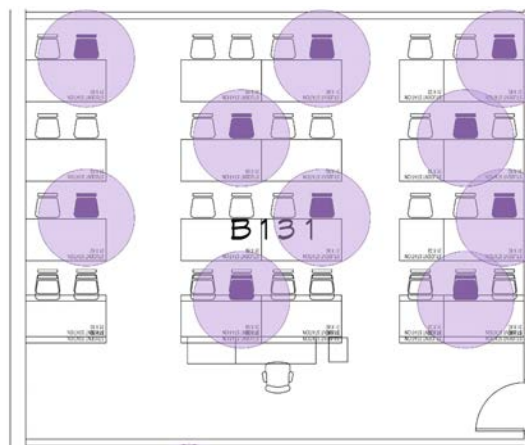
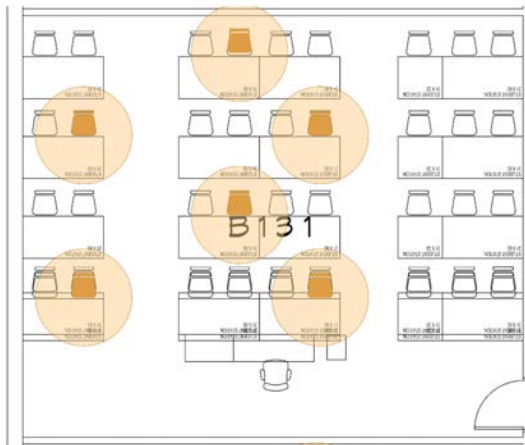
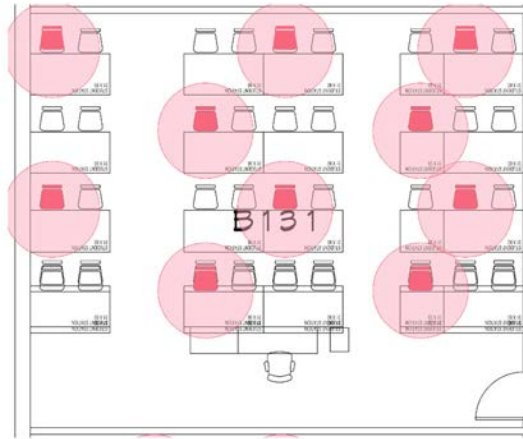

Medical Assistant
B132

Classroom Layout	Number of students
Class A (Blue)	10 students
Class B (Red)	10 students
Class C (Orange)	6 students
Class D (Purple)	10 students

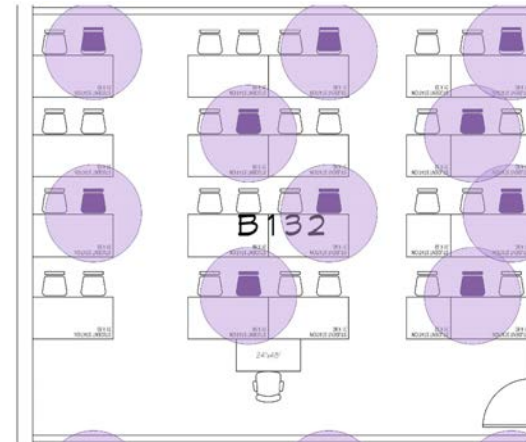
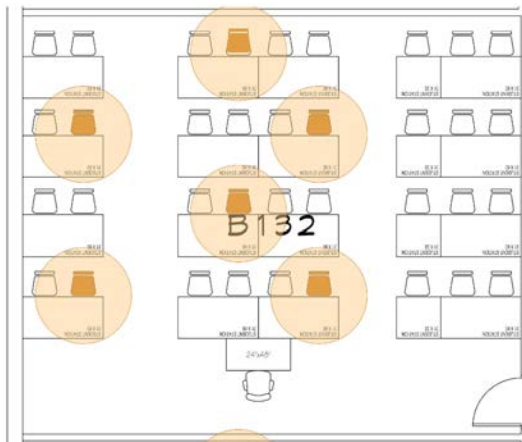
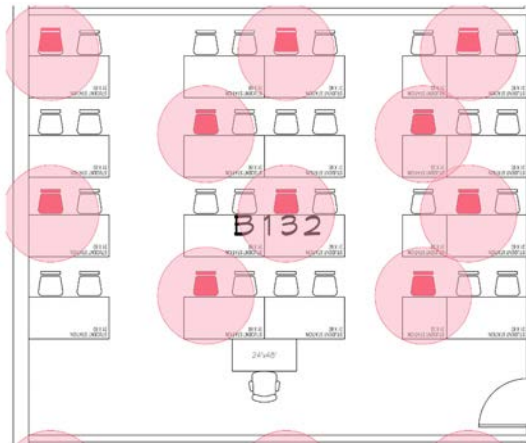
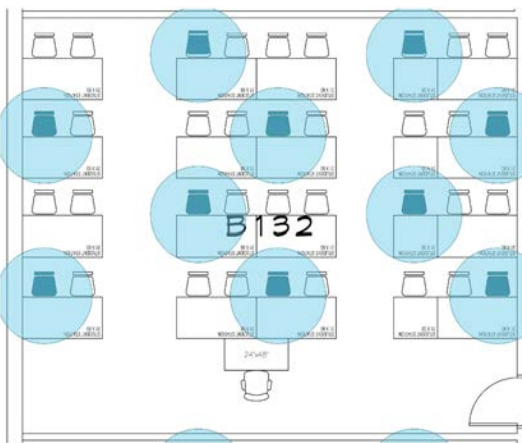

Surgical Tech E101

Classroom Layout	Number of students
Class A (Blue)	3 students

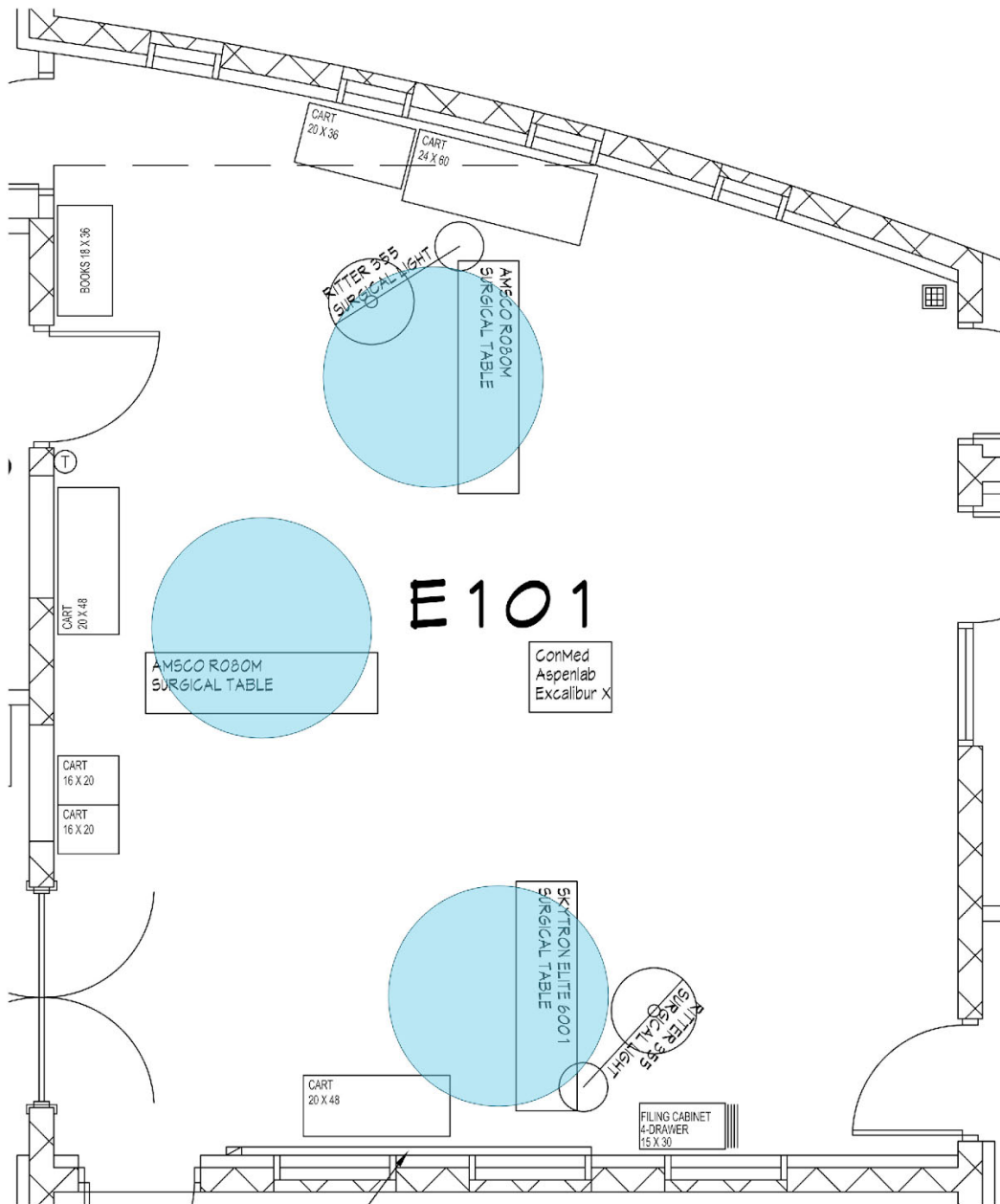

West Campus

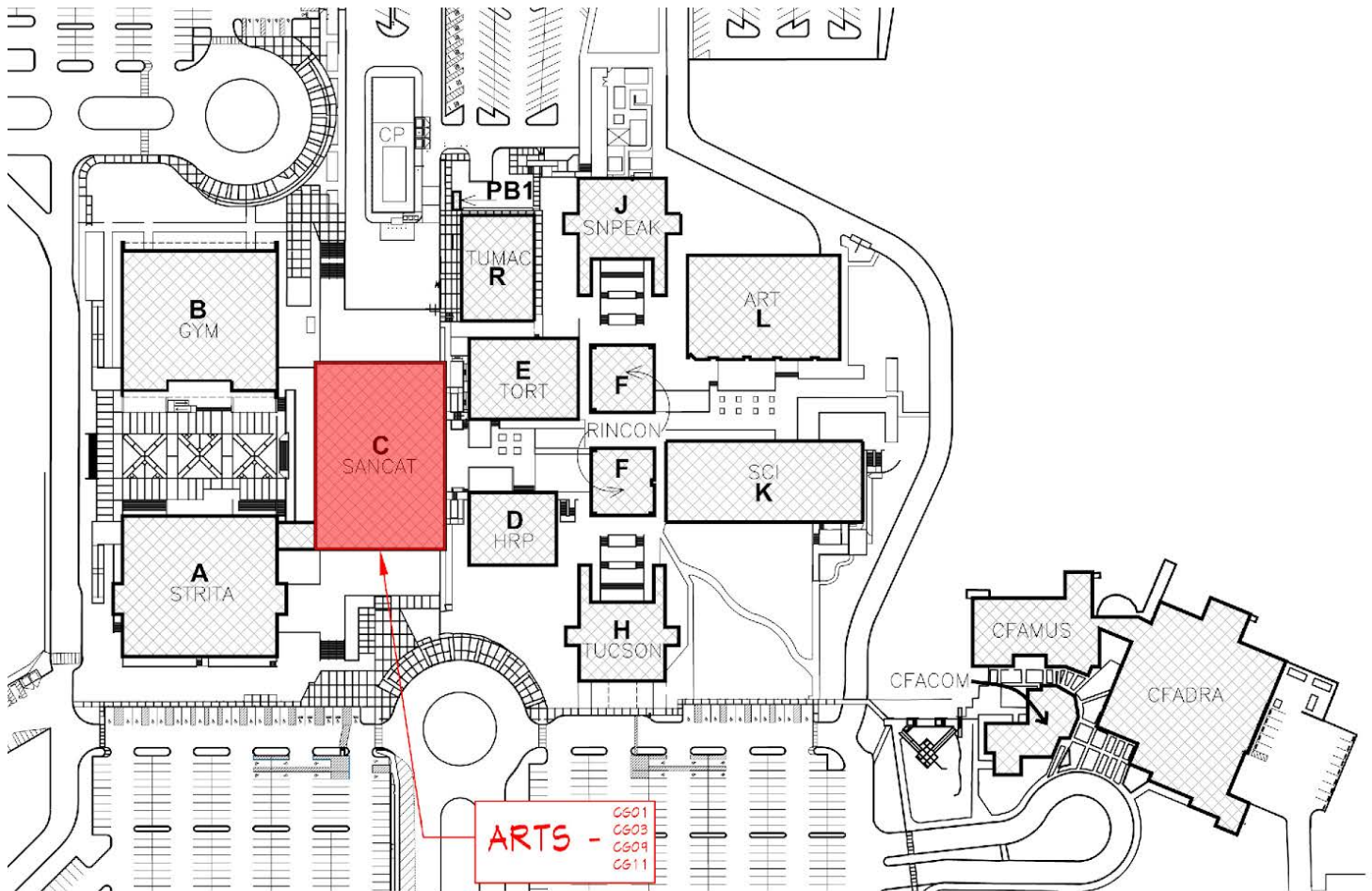

Digital Arts CG01

Classroom Layout	Number of students
Class A (Blue)	8 students
Class B (Red)	4 students

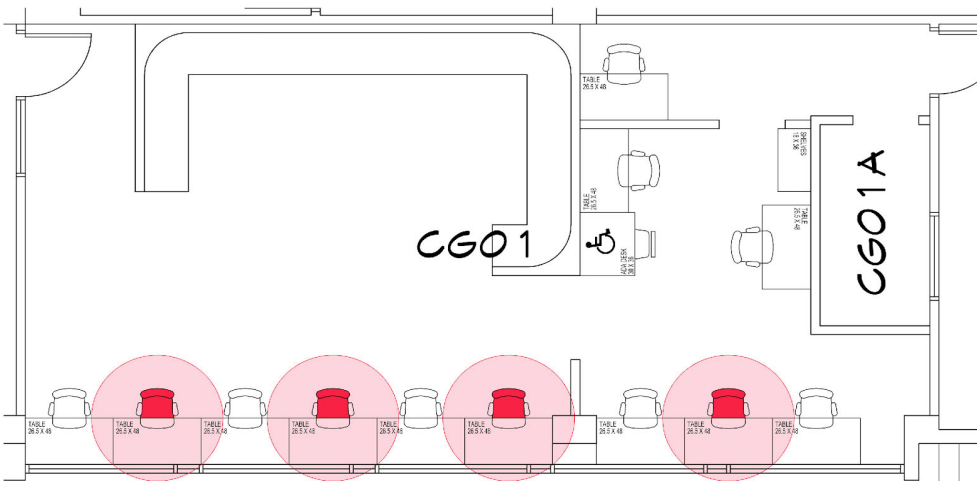
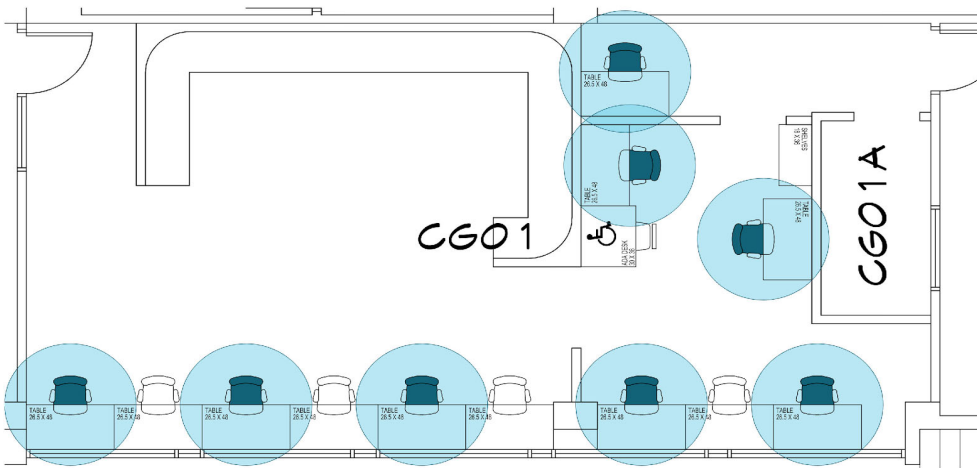

Digital Arts
CG03

Classroom Layout	Number of students
Class A (Blue)	16 students
Class B (Red)	16 students

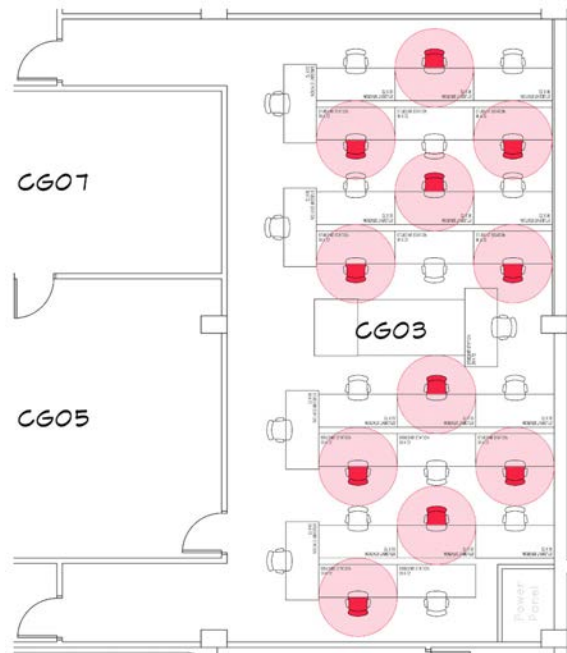
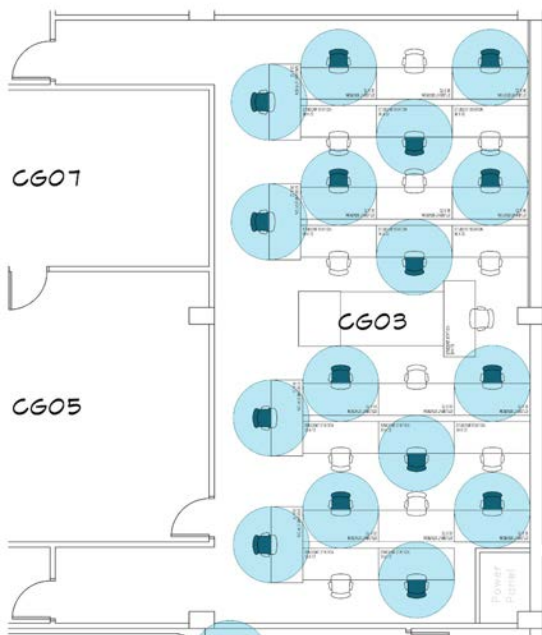

Digital Arts
CG09

Classroom Layout	Number of students
Class A (Blue)	15 students
Class B (Red)	15 students

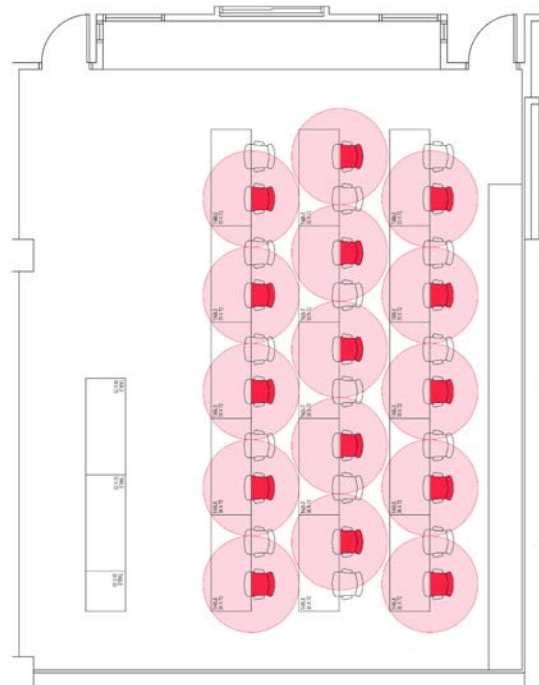
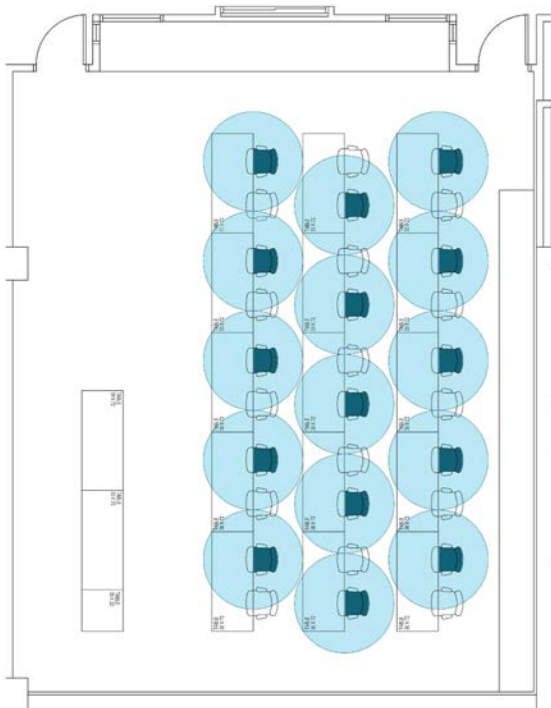

Digital Arts
CG11

Classroom Layout	Number of students
Class A (Blue)	15 students
Class B (Red)	15 students

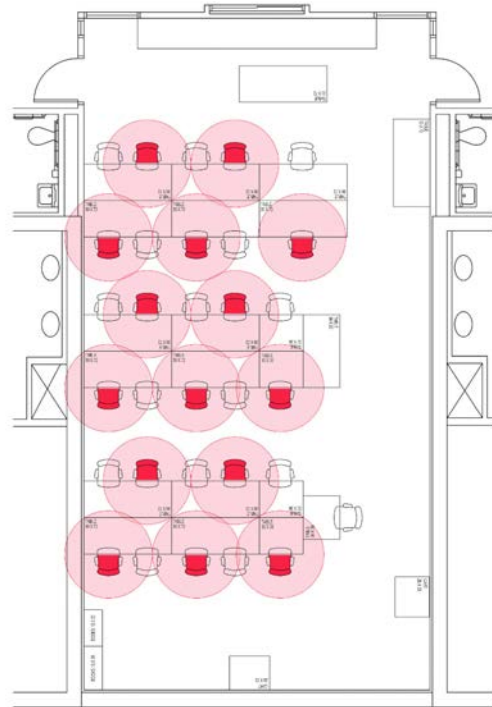
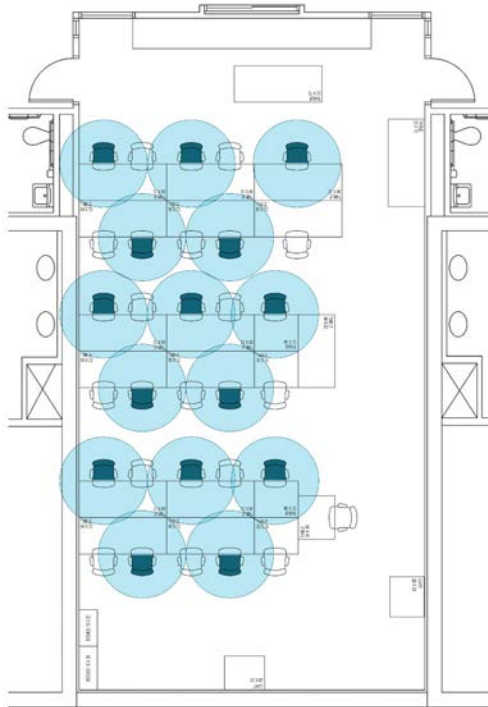

Maintenance & Security

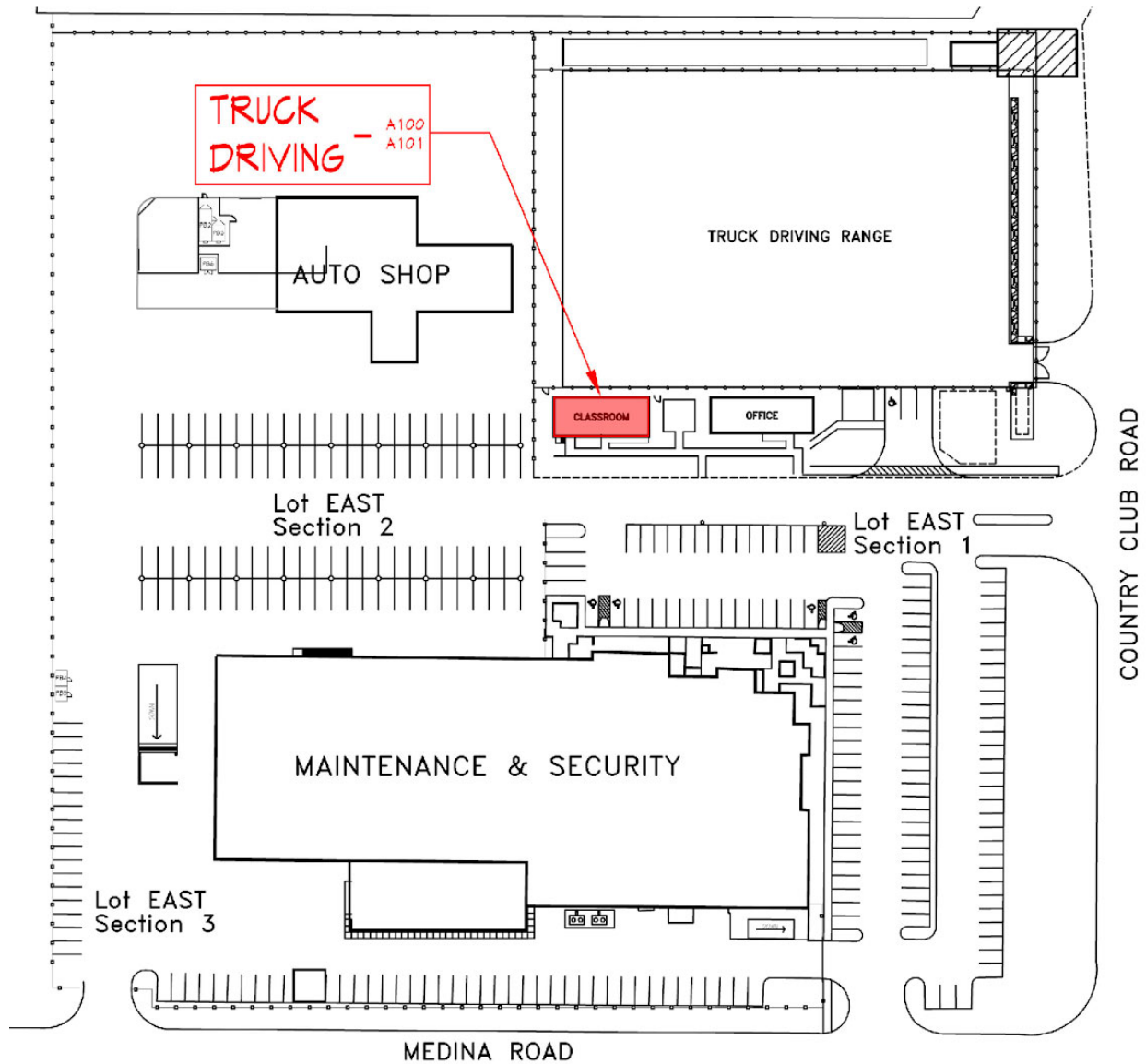

Truck Driving Range A100

Classroom Layout	Number of students
Class A (Blue)	8 students
Class B (Red)	8 students

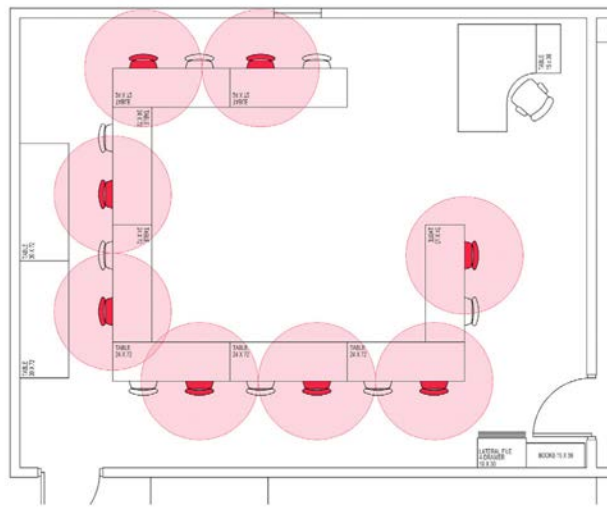
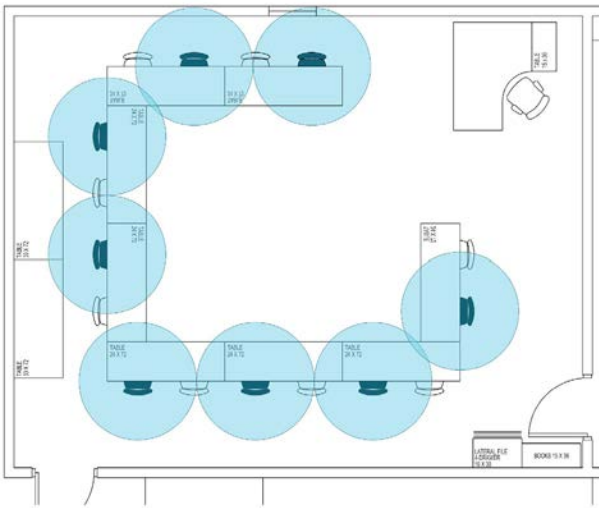

Truck Driving Range A101

Classroom Layout	Number of students
Class A (Blue)	6 students
Class B (Red)	6 students

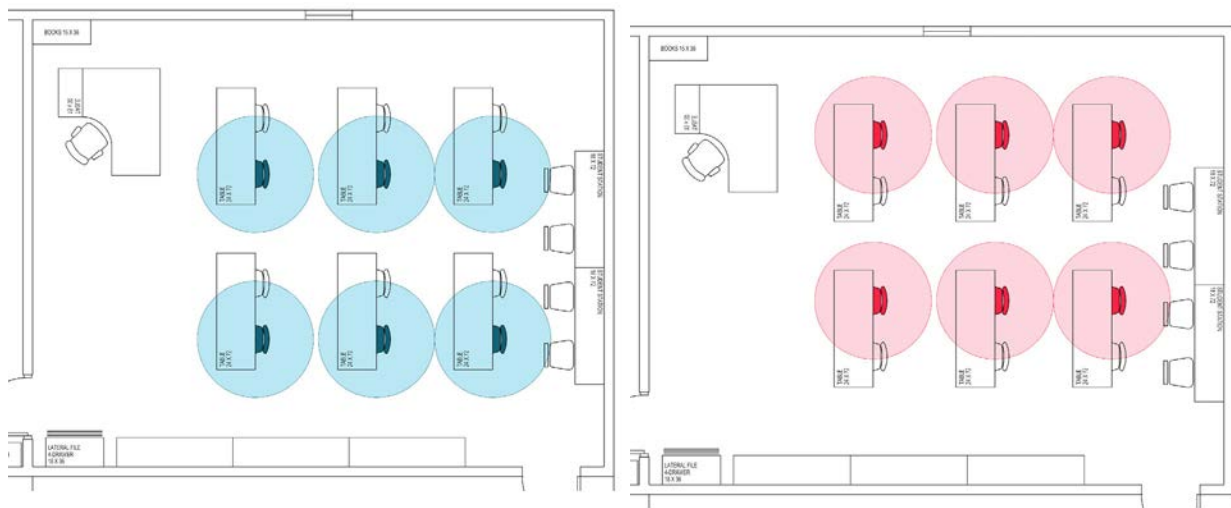

Downtown Campus

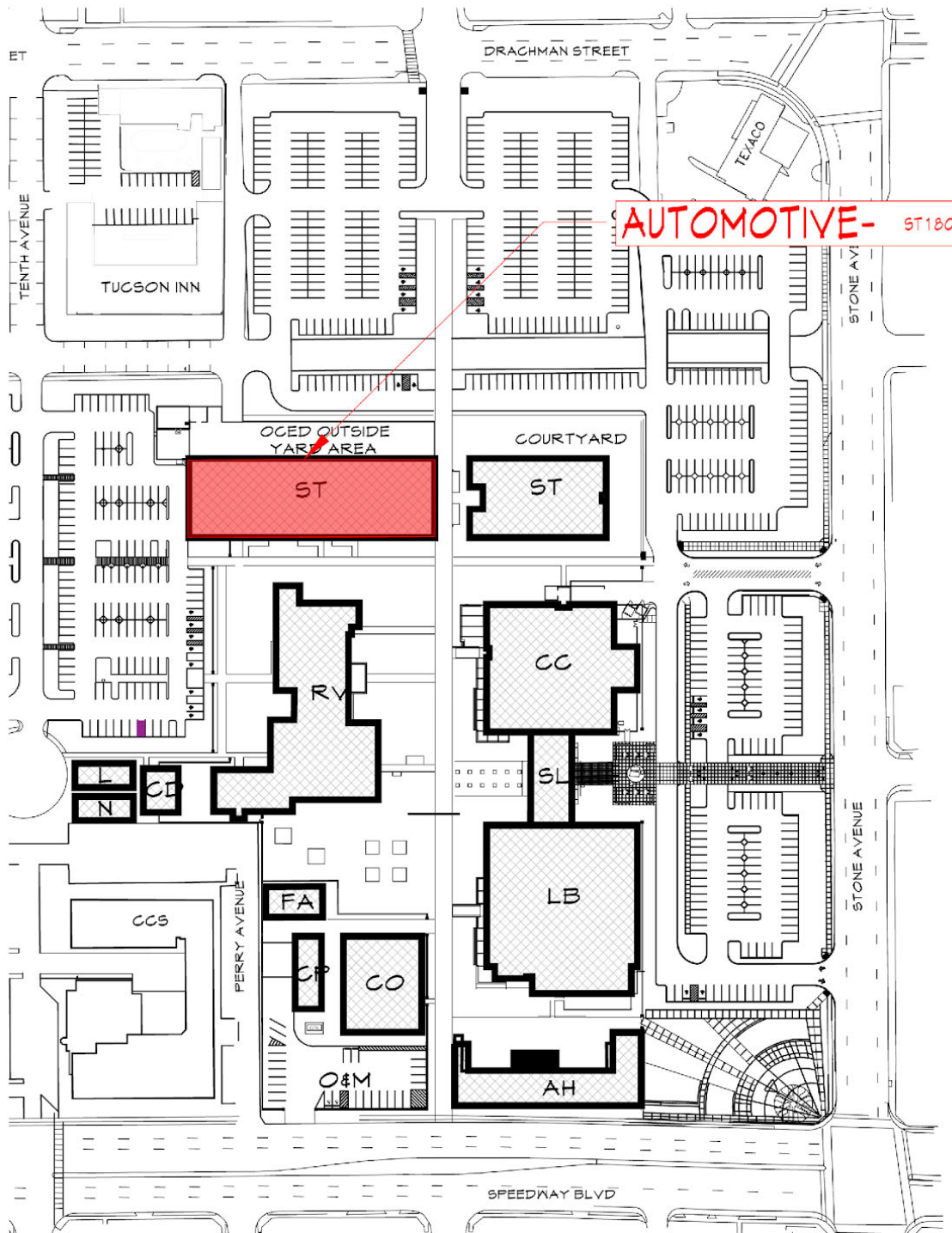

Automotive

ST180

Classroom Layout	Number of students
Class A (Blue)	14 students

